

This drawing is the property of Cathodic Anodes Australasia. To be used with permission only. This drawing becomes an uncontrolled document once issued as hard or electronic copy. Customer to confirm current revision of drawing prior to ordering.

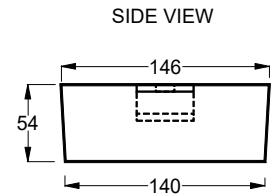

Chemical Composition Limits		Alloy:
Element	min.	max.
Standard: AS2239 (Most current)		A6
Aluminium		
Zinc	2.0	6.0
Indium	0.01	0.02
Cadmium	-	0.005
Silicon	0.08	0.12
Iron	-	0.12
Magnesium	-	0.02
Titanium	-	0.02
Copper	-	0.006
Tin	-	0.02
Other Impurities	-	-
- each	-	0.02
- total	-	0.05
Aluminium	remainder	

- Notes
1. Anodes are cast to comply with CAA's standard casting tolerances
 2. All sharp edges removed for safe handling
 3. Anode insert material to meet relevant Australian/International specifications

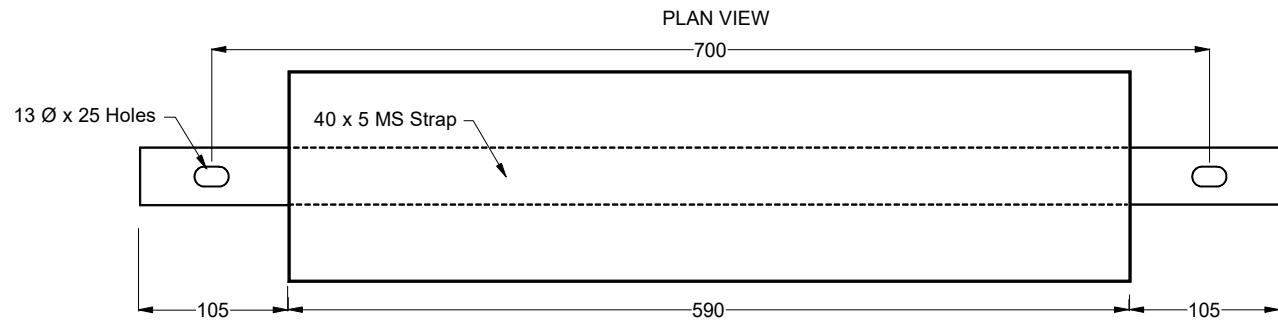

Nett Weight Kg (nominal)	Gross Weight Kg (nominal)
11.9	13.1

CAA
Cathodic Anodes Australasia
cathodicanodes.com.au

Product Aluminium Anode	
Part no. CDA-13S Type 2 with holes	Scale 1 to 5
Drawing no. CD3836	Rev Sheet 1 1 of 1
Drawn by: BL	Date: 16DEC08
Mould no: 8	All dimensions are in mm (nominal)

Rev	Details of Change(s)	Date	Initials
1	For manufacture	16DEC08	BL

