

This drawing is the property of Cathodic Anodes Australasia. To be used with permission only.
 This drawing becomes an uncontrolled document once issued as hard or electronic copy.
 Customer to confirm current revision of drawing prior to ordering.

4 3 2 1

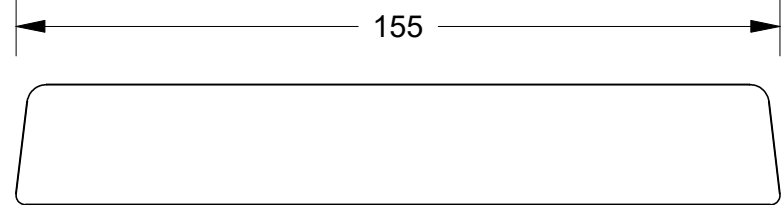
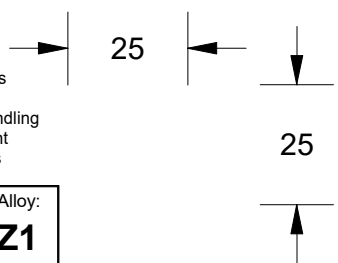
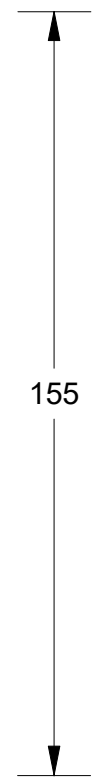
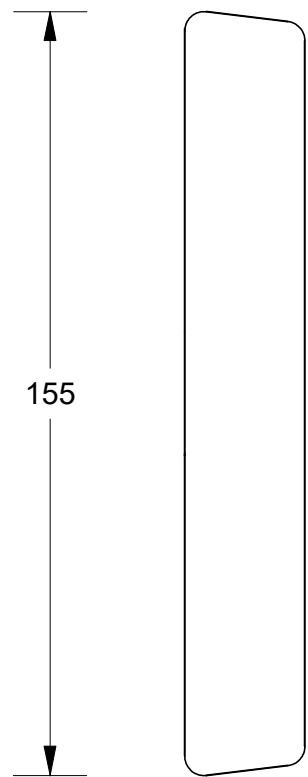

CDQ
 CAST INDENTATION LETTERING

All dimensions are in mm (nominal)

- Notes
1. Anodes are cast to comply with CAA's standard casting tolerances
 2. All sharp edges removed for safe handling
 3. Anode insert material to meet relevant Australian/International specifications

Chemical Composition Limits		Alloy:
Standard: AS2239* ^(Most current revision)		Z1
Element	min.	max.
Cadmium	0.025	0.07
Aluminium	0.10	0.50
Silicon	-	0.005
Copper	-	0.005
Iron	-	0.005
Lead	-	0.006
Other Impurities		
- each	-	0.005
- total	-	0.02
Zinc	remainder	

* Corresponds to MIL-DTL-18001L alloy composition



Nett Weight Kg (nominal)	Gross Weight Kg (nominal)
4.0	4.0

Rev	Details of Change(s)	Date	Initials
1	Cathodic Diecasting Original	08 JUN 04	GPC
2	2013 Catalogue Version (CAA Logo)	20 DEC 13	R.N.

CAA
 Cathodic Anodes Australasia
 cathodicanodes.com.au

Product Zinc Anode		Scale 1 : 1.5	
Part no. CDZ1-66-1		Rev 2	Sheet 1 of 1
Drawing No: CD3709		Date: 20 DEC 2013	
Drawn by: R Northey		Mould No: 51	

4 3 2 1