

This drawing is the property of Cathodic Anodes Australasia. To be used with permission only. This drawing becomes an uncontrolled document once issued as hard or electronic copy. Customer to confirm current revision of drawing prior to ordering.

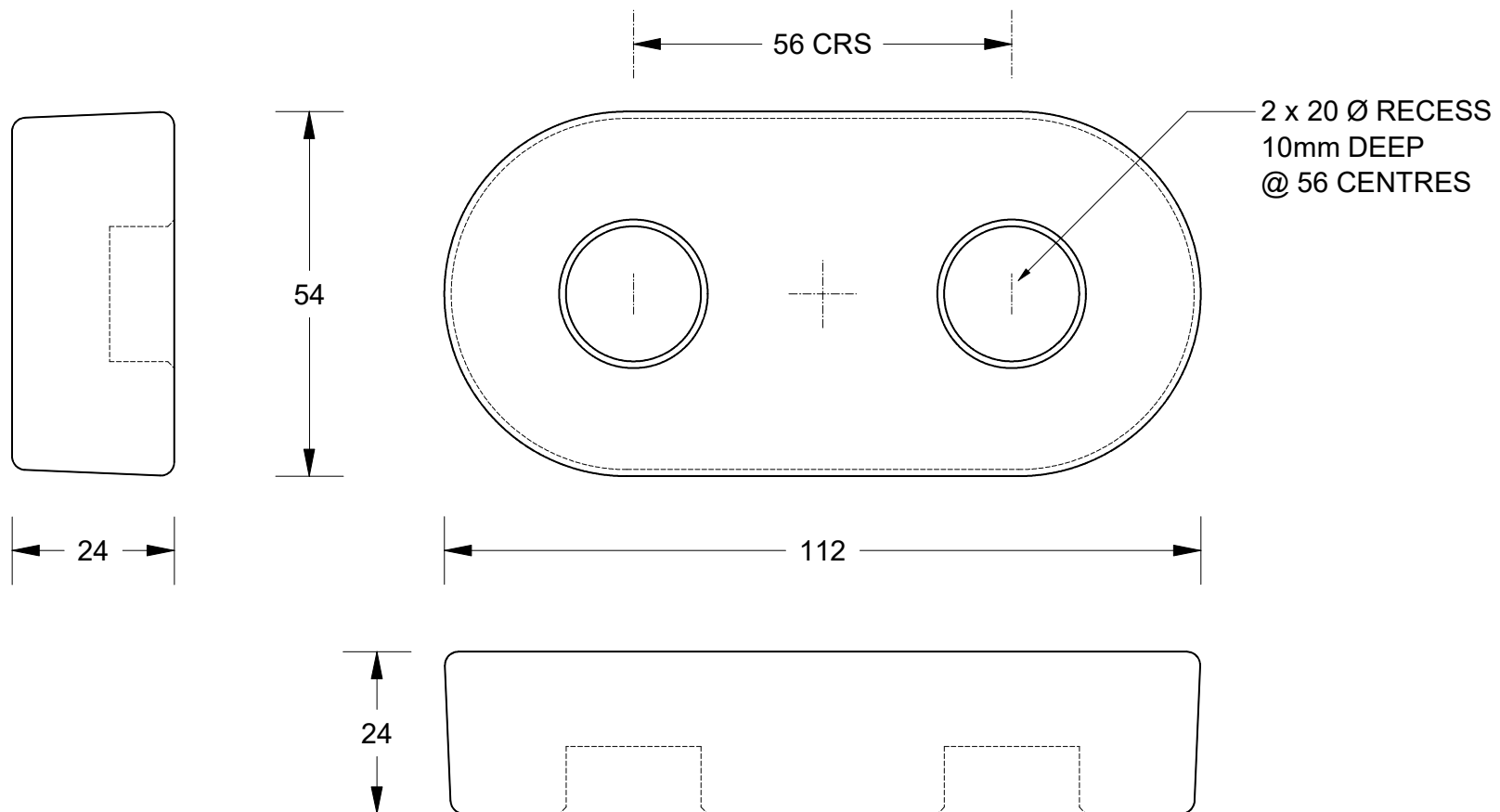

Chemical Composition Limits			Alloy:
Standard: AS2239* (Most current revision)			Z1
Zinc			
Element	min.	max.	
Cadmium	0.025	0.07	
Aluminium	0.10	0.50	
Silicon	-	0.005	
Copper	-	0.005	
Iron	-	0.005	
Lead	-	0.006	
Other Impurities			
- each	-	0.005	
- total	-	0.02	
Zinc	remainder		

* Corresponds to MIL-DTL-18001L alloy composition

Notes

1. Anodes are cast to comply with CAA's standard casting tolerances
2. All sharp edges removed for safe handling
3. Anode insert material to meet relevant Australian/International specifications



Nett Weight Kg (nominal)	Gross Weight Kg (nominal)
0.820	0.820



Cathodic Anodes Australasia

cathodicanodes.com.au

Rev	Details of Change(s)	Date	Initials
1	For Manufacture	23 JAN 13	R.N.

Product	
Zinc Anode	
Part no.	Scale
Intake Body Anode (DJ 994)	1 : 1
Drawing No: CD3544	Rev Sheet
	1 1 of 1
Drawn by: R Northey Date: 23 JAN 2013	
All dimensions are in mm (nominal)	