

Chemical Composition Limits Standard: AS2239 -2003*			Alloy: Z1
Element	Min	Max	
Zinc			
Cadmium	0.025	0.070	
Aluminium	0.10	0.50	
Silicon	—	0.005	
Copper	—	0.005	
Iron	—	0.005	
Lead	—	0.006	
Other Impurities	- Each	0.005	
	- Total	0.02	
Zinc		remainder	

* Corresponds to MIL-A-18001k alloy composition.

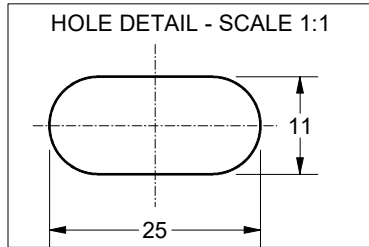

REPLACES GENUINE VOLVO P/No:

- Notes
1. Anodes are cast to comply with Cathodic Anodes Australasia's standard casting tolerances
 2. All sharp edges removed for safe handling

Nett Weight Kg (nominal)	Gross Weight Kg (nominal)
5.00	5.30



Product Zinc Anode		Scale 1 to 2
Part no. CDZ - 355 x 75 x 30		Rev Sheet 2 1 of 1
Drawing no. CD3512		Rev Sheet 2 1 of 1
Drawn by: R Northey Date: 16 NOV 2012		
All dimensions are in mm (nominal)		Mould No: D/L

Rev	Details of Change(s)	Date	Initials
1	For Quotation	16NOV12	R.N.
2	S/S Insert, Clearance, Taper & Weight	07DEC12	R.N.