

This drawing is the property of Cathodic Anodes Australasia. To be used with permission only. This drawing becomes an uncontrolled document once issued as hard or electronic copy. Customer to confirm current revision of drawing prior to ordering.

PLAN VIEW

2 x (22 Ø x 28) SLOTTED HOLES @ 150 CRS

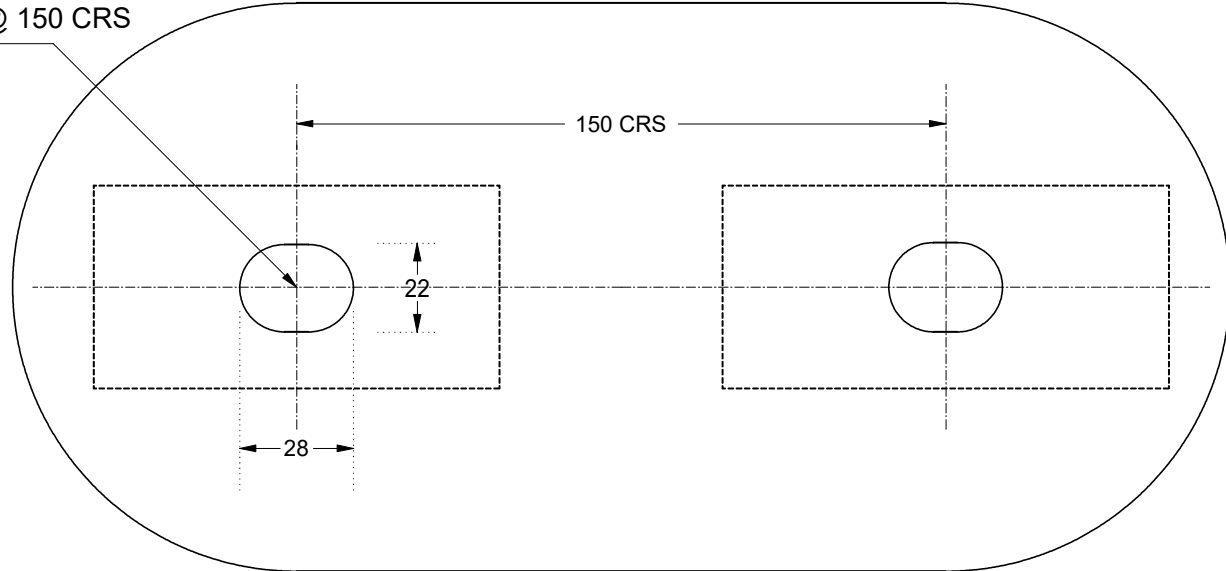

145

INSERTS 110 x 50 x 3

SIDE VIEW

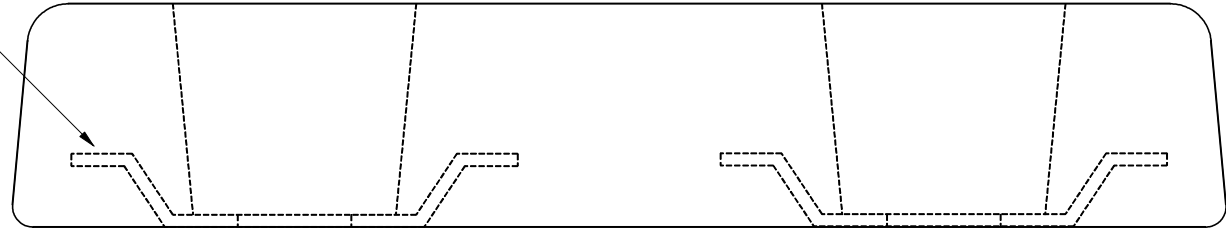

305

41

Chemical Composition Limits		Alloy:
Standard: AS2239* (Most current revision)		Z1
Element	min.	max.
Cadmium	0.025	0.07
Aluminium	0.10	0.50
Silicon	-	0.005
Copper	-	0.005
Iron	-	0.005
Lead	-	0.006
Other Impurities	-	-
- each	-	0.005
- total	-	0.02
Zinc	-	remainder

* Corresponds to MIL-DTL-18001L alloy composition

- Notes
1. Anodes are cast to comply with CAA's standard casting tolerances
 2. All sharp edges removed for safe handling
 3. Anode insert material to meet relevant Australian/International specifications



Nett Weight Kg (nominal)	Gross Weight Kg (nominal)
9.90	10.2



cathodicanodes.com.au

Product Zinc Anode		Scale 1 to 2
Part no. CDZ8-126-1.60H		Rev Sheet 1 1 of 1
Drawing no. CD3489		Rev Sheet 1 1 of 1
Drawn by: R Northey Date: 18 OCT 12		
All dimensions are in mm (nominal) Mould No:		

Rev	Details of Change(s)	Date	Initials
1	For Quotation	18OCT12	R.N.