

**Sheet 2 - Machining Detail - Identical Halves**

This drawing is the property of Cathodic Anodes Australasia. To be used with permission only. This drawing becomes an uncontrolled document once issued as hard or electronic copy. Customer to confirm current revision of drawing prior to ordering.

TAP: M12 x 30 + 13 mm Clearance, 2 x Each Half - One Side Only

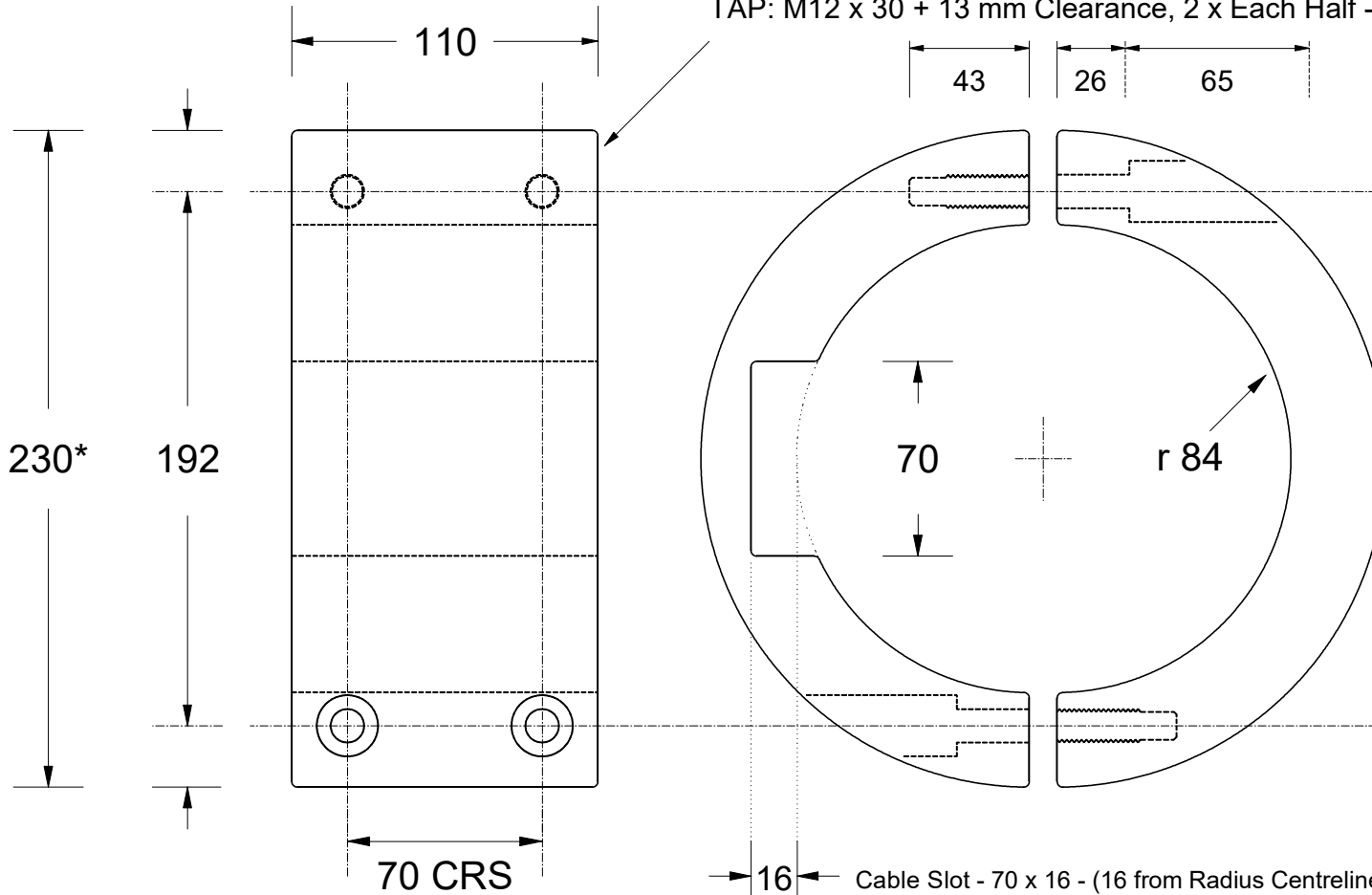

Drill 12.5  
 Counter-Bore 22  
 Ø Ø  
 2 x Each Half - One Side Only

Outside Faces = "As Cast"  
 Pairing Faces = Machined  
 Inside Diameter = Machined

Chemical Composition Limits		Alloy:
Standard: AS2239* (Most current revision)		<b>Z1</b>
Zinc		
Element	min.	max.
Cadmium	0.025	0.07
Aluminium	0.10	0.50
Silicon	-	0.005
Copper	-	0.005
Iron	-	0.005
Lead	-	0.006
Other Impurities		
- each	-	0.005
- total	-	0.02
Zinc	remainder	

\* Corresponds to MIL-DTL-18001L alloy composition

**Notes**

- Anodes are cast to comply with CAA's standard casting tolerances
- All sharp edges removed for safe handling
- Anode insert material to meet relevant Australian/International specifications



Rev	Details of Change(s)	Date	Drawn	Verified
1	Original Manufacture	09 July 2012	R.N.	R.G.
2	2016 Revision	22 January 2016	R.N.	R.G.

All dimensions are in mm (nominal)

**CAA**  
 Cathodic Anodes Australasia  
 cathodicanodes.com.au

Product <b>Zinc Anode - Shaft Anode</b>		Scale <b>1 : 2.5</b>	
Part no. <b>CDZ4 - 660 Type 2</b>		Rev <b>2</b>	Sheet <b>2 of 2</b>
Drawing No: <b>CD3429</b>		Drawn by: R Northey Date: 22 JAN 2016	