

This drawing is the property of Cathodic Anodes Australasia. To be used with permission only. This drawing becomes an uncontrolled document once issued as hard or electronic copy. Customer to confirm current revision of drawing prior to ordering.

4 x M12 x 50mm 304 S/S Socket Head Cap Screws, 4 x M12 304 S/S Internal Tooth Washers

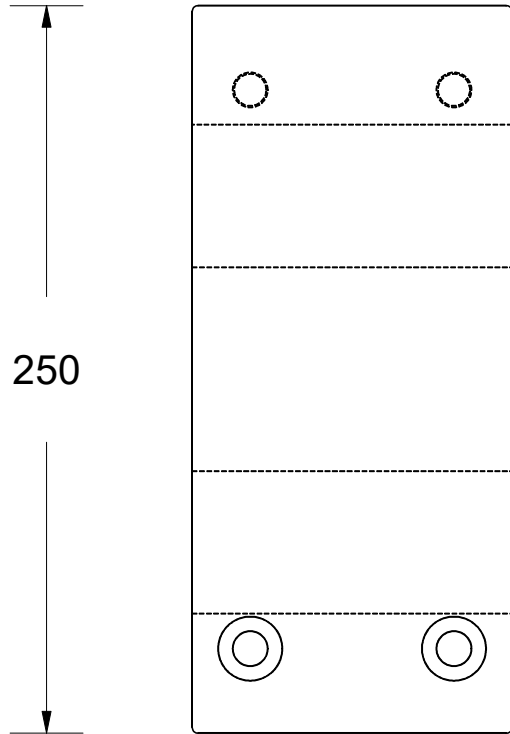

Outside Ø 250

Inside Ø 168

70

41

16

Cable Slot - 70 x 16 - (16 from Radius Centreline) - One Side Only

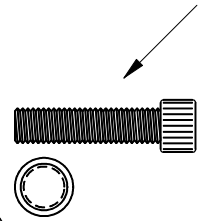

See Sheet 2 for Machining Detail

Casting Note: Made from a 1/2 Bush Casting - 250 O/D, 165 I/D, 115 H

All dimensions are in mm (nominal)

Chemical Composition Limits			Alloy:
Standard: AS2239* (Most current revision)			Z1
Zinc			
Element	min.	max.	
Cadmium	0.025	0.07	
Aluminium	0.10	0.50	
Silicon	-	0.005	
Copper	-	0.005	
Iron	-	0.005	
Lead	-	0.006	
Other Impurities			
- each	-	0.005	
- total	-	0.02	
Zinc		remainder	

* Corresponds to MIL-DTL-18001L alloy composition

Notes

- Anodes are cast to comply with CAA's standard casting tolerances
- All sharp edges removed for safe handling
- Anode insert material to meet relevant Australian/International specifications



Rev	Details of Change(s)	Date	Drawn	Verified
1	Original Manufacture	09 July 2012	R.N.	R.G.
2	2016 Revision	22 January 2016	R.N.	R.G.

Nett Weight Kg (nominal)	Gross Weight Kg (nominal)
19.0	19.2

CAA
Cathodic Anodes Australasia
cathodicanodes.com.au

Product			
Zinc Anode - Shaft Anode			
Part no.	Scale		
CDZ4 - 660 Type 1	1 : 2.5		
Drawing No:	Rev	Sheet	
CD3428	2	1 of 2	
Drawn by: R Northey	Date: 22 JAN 2016		

