

This drawing is the property of Cathodic Anodes Australasia. To be used with permission only. This drawing becomes an uncontrolled document once issued as hard or electronic copy. Customer to confirm current revision of drawing prior to ordering.

4 x M12 x 50mm 304 S/S Socket Head Cap Screws, 4 x M12 304 S/S Internal Tooth Washers

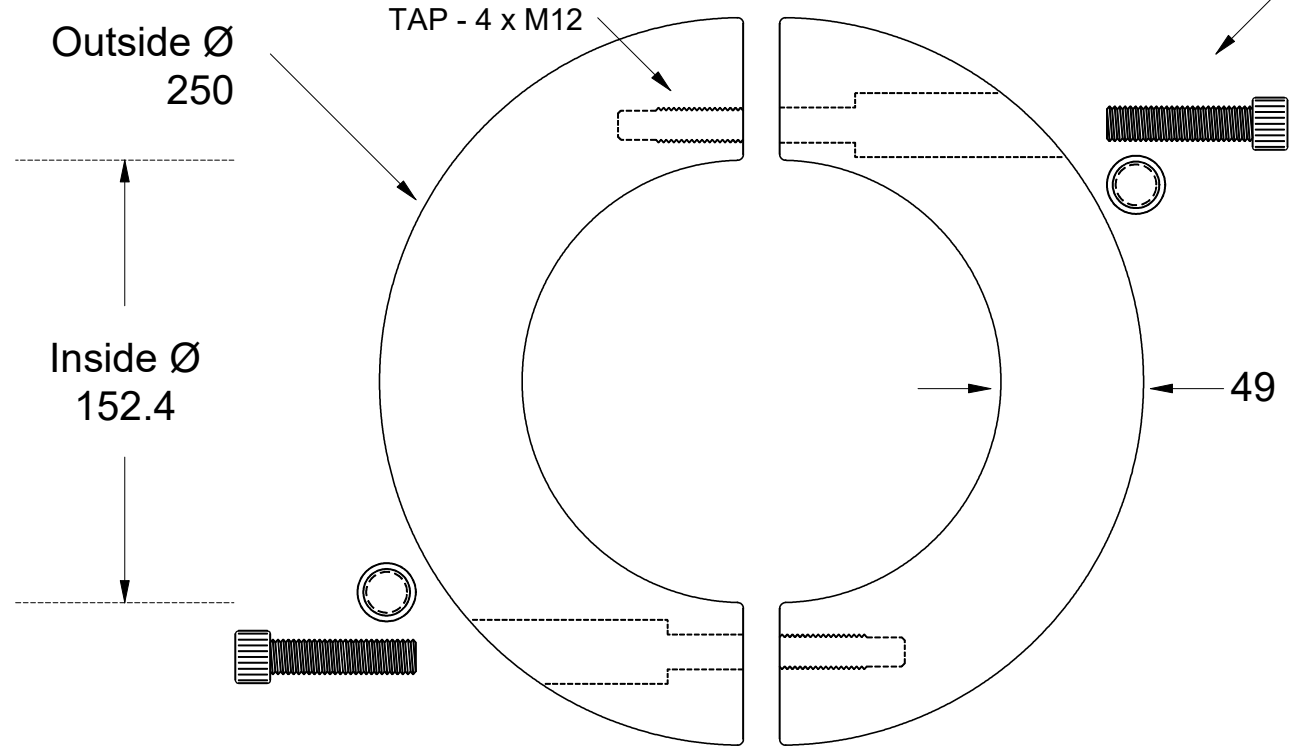
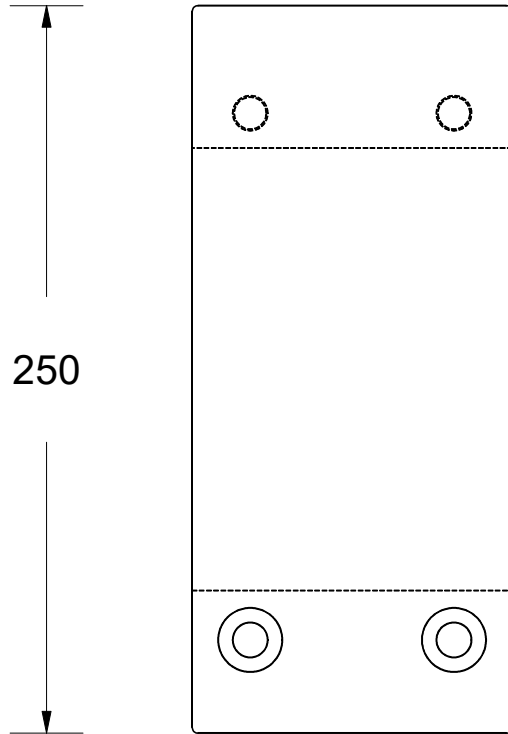

Intended Use For 6" IMPERIAL Shafts - See Sheet 2 for Machining Detail

Casting Note: Made from a 250 (OD) x 150 (ID) x 110 (H) Cast Bush - Split by Machine Shop

All dimensions are in mm (nominal)

Chemical Composition Limits			Alloy:
Standard: AS2239* (Most current revision)			Z1
Zinc			
Element	min.	max.	
Cadmium	0.025	0.07	
Aluminium	0.10	0.50	
Silicon	-	0.005	
Copper	-	0.005	
Iron	-	0.005	
Lead	-	0.006	
Other Impurities			
- each	-	0.005	
- total	-	0.02	
Zinc	remainder		

* Corresponds to MIL-DTL-18001L alloy composition

Notes

1. Anodes are cast to comply with CAA's standard casting tolerances
2. All sharp edges removed for safe handling
3. Anode insert material to meet relevant Australian/International specifications



Nett Weight Kg (nominal)	Gross Weight Kg (nominal)
24.1	24.3

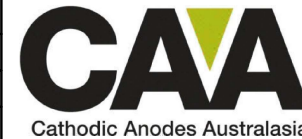

cathodicanodes.com.au

Rev	Details of Change(s)	Date	Drawn	Verified
1	For Quotation	22 January 2016	R.N.	R.G.

Product			
Zinc Anode - Shaft Anode			
Part no.	Scale		
CDZ4 - 600	1 : 2.5		
Drawing No:	Rev	Sheet	
CD3369	1	1 of 2	
Drawn by: R Northey	Date: 22 JAN 2016		