

This drawing is the property of Cathodic Anodes Australasia. To be used with permission only.
 This drawing becomes an uncontrolled document once issued as hard or electronic copy.
 Customer to confirm current revision of drawing prior to ordering.

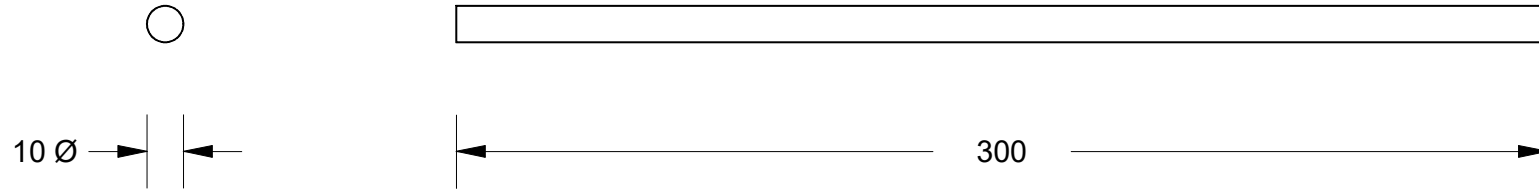

Chemical Composition Limits			Alloy: Z1
Standard: AS2239* (Most current revision)			
Element	min.	max.	
Cadmium	0.025	0.07	
Aluminium	0.10	0.50	
Silicon	-	0.005	
Copper	-	0.005	
Iron	-	0.005	
Lead	-	0.006	
Other Impurities			
- each	-	0.005	
- total	-	0.02	
Zinc	remainder		

* Corresponds to MIL-DTL-18001L alloy composition

Notes

1. Anodes are cast to comply with CAA's standard casting tolerances
2. All sharp edges removed for safe handling
3. Anode insert material to meet relevant Australian/International specifications



All dimensions are in mm (nominal)

Rev	Details of Change(s)	Date	Drawn	Verified	Product	
1	2013 Catalogue Version (CAA Logo)	15 December 2015	R.N.	R.G.	Zinc Anode - Extruded Zinc Rod	
					Part no.	Scale
					CDZ5-375-12E	1 : 2
					Drawing No: CD3335	Rev Sheet
						1 1 of 1
					Drawn by: R Northey Date: 15 DEC 2015	
					Mould No: N/A Tooling: N/A	



Cathodic Anodes Australasia

cathodicanodes.com.au