

This drawing is the property of Cathodic Anodes Australasia. To be used with permission only. This drawing becomes an uncontrolled document once issued as hard or electronic copy. Customer to confirm current revision of drawing prior to ordering.

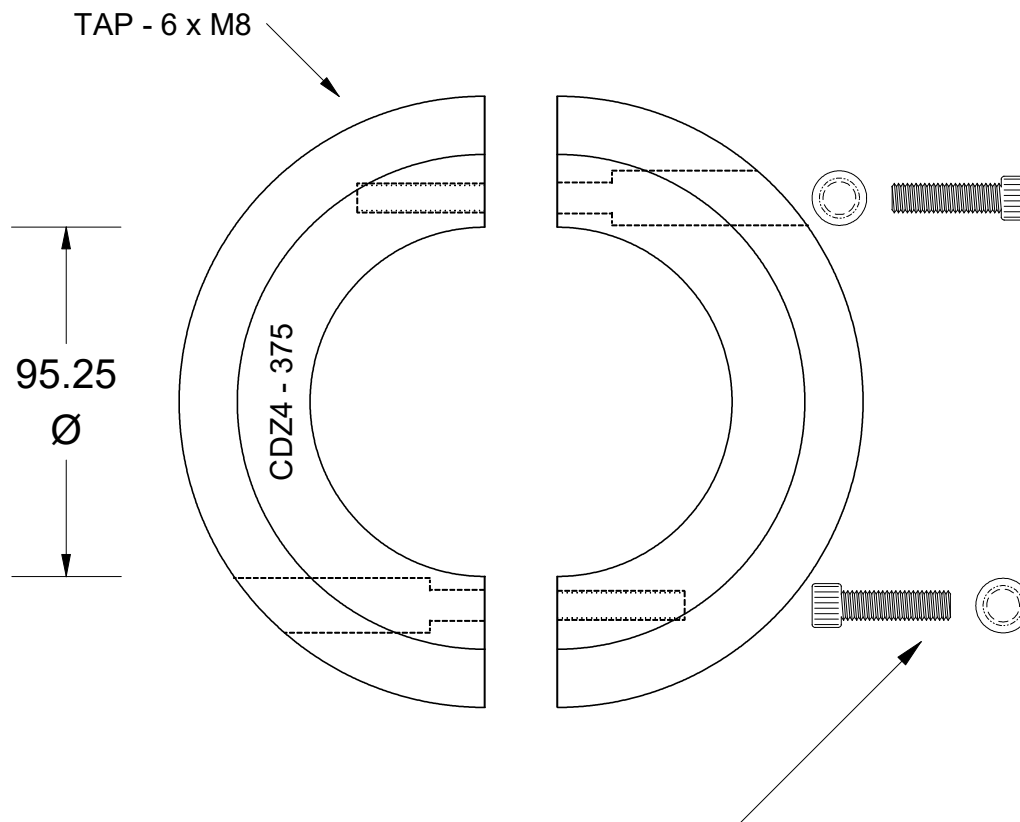
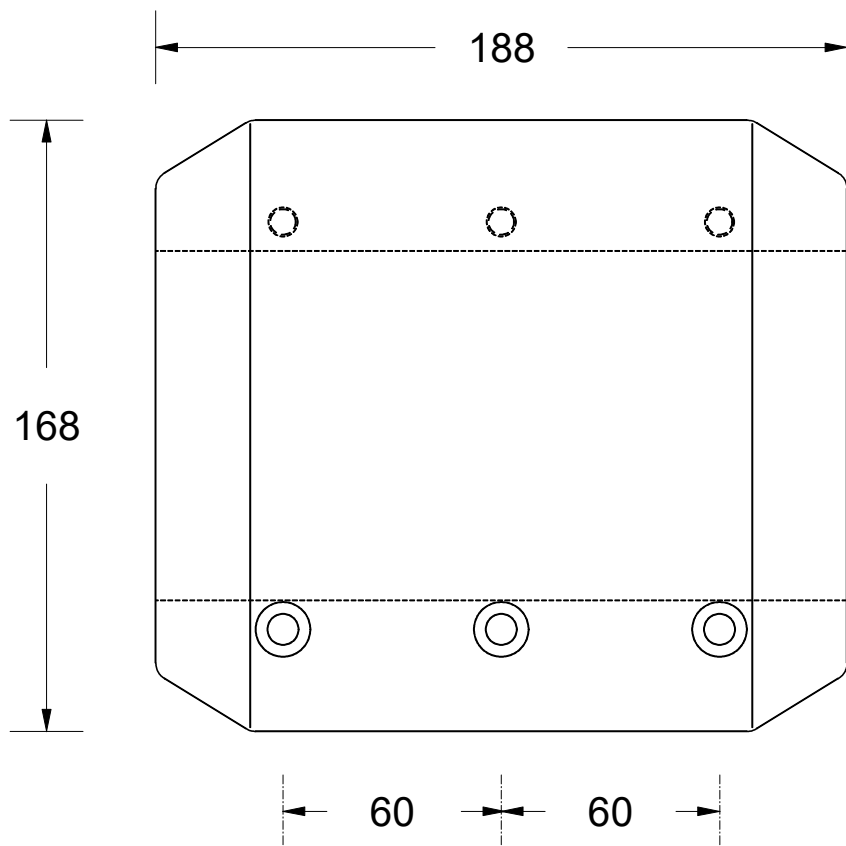

6 x M8 x 30mm 304 S/S Socket Head Cap Screws, 6 x M8 304 S/S Internal Tooth Washers

Intended Use For 3-3/4" IMPERIAL Shafts - See Sheet 2 for Machining Detail

All dimensions are in mm (nominal)

Chemical Composition Limits		Alloy:
Standard: AS2239* (Most current revision)		Z1
Zinc		
Element	min.	max.
Cadmium	0.025	0.07
Aluminium	0.10	0.50
Silicon	-	0.005
Copper	-	0.005
Iron	-	0.005
Lead	-	0.006
Other Impurities		
- each	-	0.005
- total	-	0.02
Zinc	remainder	

* Corresponds to MIL-DTL-18001L alloy composition

Notes

- Anodes are cast to comply with CAA's standard casting tolerances
- All sharp edges removed for safe handling
- Anode insert material to meet relevant Australian/International specifications



Rev	Details of Change(s)	Date	Drawn	Verified
1	Cathodic Diecasting Original	11 September 2011	R.N.	R.G.
2	2013 Catalogue Version (CAA Logo)	15 January 2016	R.N.	R.G.

Nett Weight Kg (nominal)	Gross Weight Kg (nominal)
18.4	18.5



Cathodic Anodes Australasia

cathodicanodes.com.au

Product	
Zinc Anode - Shaft Anode	
Part no.	Scale
CDZ4 - 375	1 : 2
Drawing No: CD3193	Rev Sheet
	2 1 of 2
Drawn by: R Northey Date: 15 JAN 2016	