

This drawing is the property of Cathodic Anodes Australasia. To be used with permission only.
 This drawing becomes an uncontrolled document once issued as hard or electronic copy.
 Customer to confirm current revision of drawing prior to ordering.

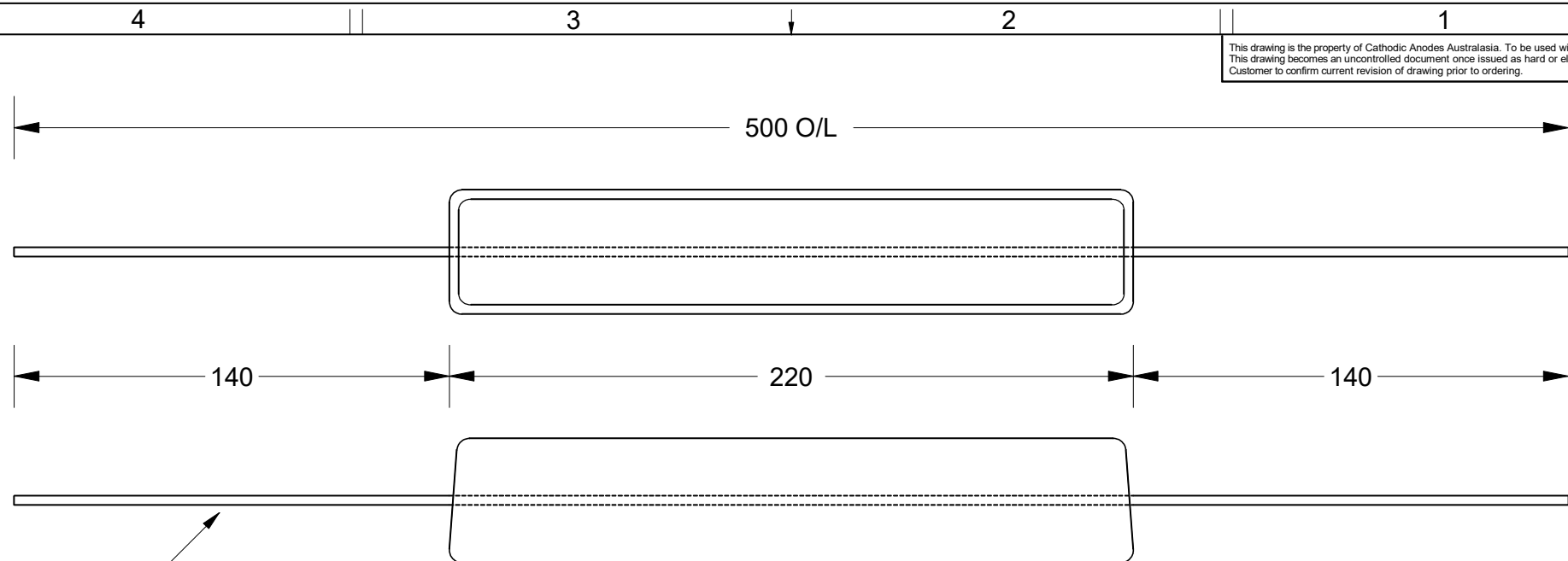

2.5mm Ø "Soft Gal" (Annealed) Steel Wire

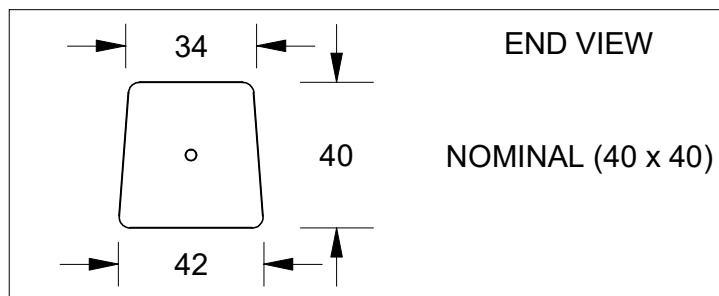

Chemical Composition Limits			Alloy: A1
Standard: AS2239 (Most current revision)			
Aluminium			
Element	min.	max.	
Zinc	2.1	2.7	
Indium	0.017	0.025	
Cadmium	0.008	0.012	
Silicon	-	0.20	
Iron	-	0.12	
Copper	-	0.006	
Other Impurities			
- each	-	0.02	
- total	-	0.05	
Aluminium	remainder		

Notes

1. Anodes are cast to comply with CAA's standard casting tolerances
2. All sharp edges removed for safe handling
3. Anode insert material to meet relevant Australian/International specifications



All dimensions are in mm (nominal)

Rev	Details of Change(s)	Date	Nett Weight		Gross Weight	
			Kg (nominal)		Kg (nominal)	
			0.800		N/A	
1	Cathodic Diecasting Original	19 May 2009		<i>B.L.</i>	<i>R.G.</i>	
2	2013 Catalogue Version (CAA Logo)	10 January 2014		<i>R.N.</i>	<i>R.G.</i>	
3	2.5mm Ø "Soft Gal" (Annealed) Steel Wire	27 January 2016		<i>R.N.</i>	<i>J.L.</i>	



Cathodic Anodes Australasia

cathodicanodes.com.au

Product			
Aluminium Anode			
Part no.		Scale	
CDA-000 (A1)		1 : 2	
Drawing No: CD3126		Rev	Sheet
		3	1 of 1
Drawn by: R Northey Date: 27 JAN 2016			
Mould No: 106			

