

This drawing is the property of Cathodic Anodes Australasia. To be used with permission only.
 This drawing becomes an uncontrolled document once issued as hard or electronic copy.
 Customer to confirm current revision of drawing prior to ordering.

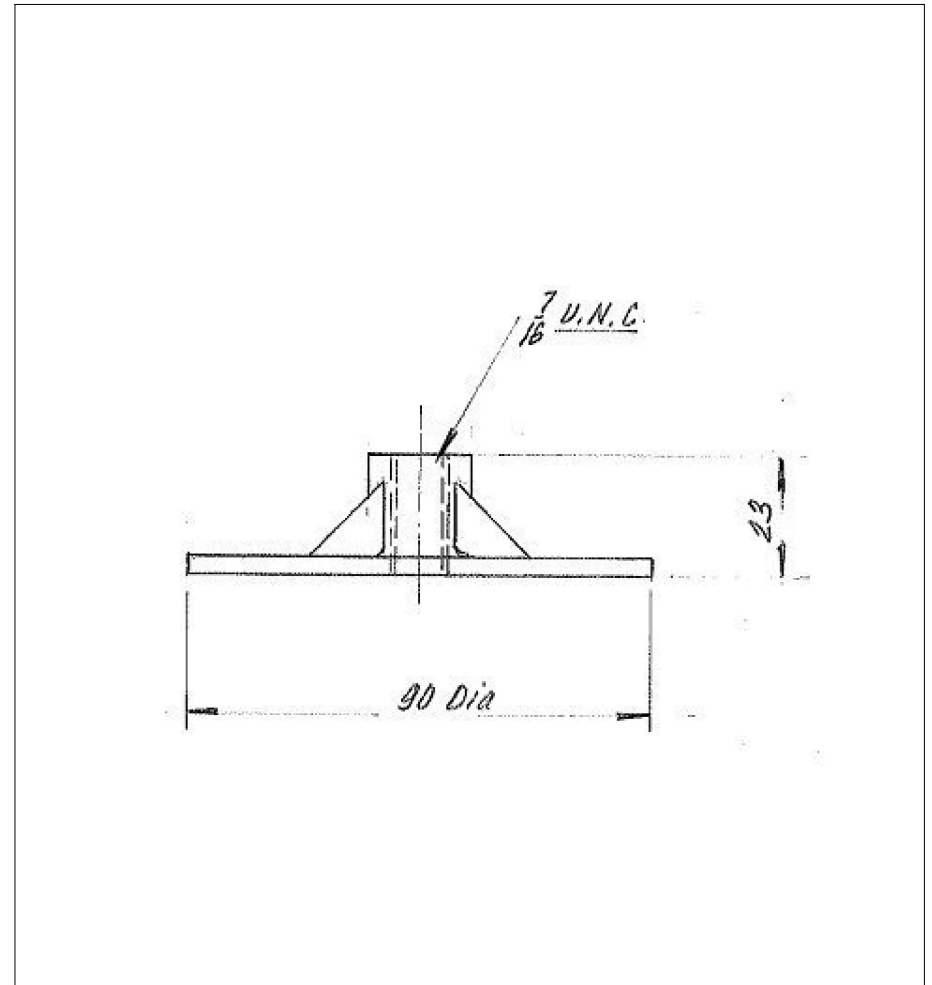

Plate (Round) Anode

Replaces Genuine Part: 76214-5

All dimensions are in mm (nominal)

Notes

1. Anodes are cast to comply with CAA's standard casting tolerances
2. All sharp edges removed for safe handling
3. Anode insert material to meet relevant Australian/International specifications

Chemical Composition Limits		Alloy:
Standard: MIL-DTL-24779A(SH)		24779A
Aluminium (Most current revision)		
Element	min.	max.
Zinc	4.0	6.5
Indium	0.014	0.020
Mercury	-	0.001
Silicon	0.08	0.20
Iron	-	0.090
Copper	-	0.004
Tin	-	0.001
Aluminium	remainder	

Rev	Details of Change(s)	Date	Drawn	Verified
1	Cathodic Diecasting Original	15 Aug 2011	R.N.	R.G.
2	2013 / 2019 Catalogue Version (CAA Logo)	21 Aug 2020	R.N.	R.G.

Nett Weight Kg (nominal)	Gross Weight Kg (nominal)
0.110	0.110

CAA
 Cathodic Anodes Australasia
cathodicanodes.com.au

Product		Aluminium Anode	
Part no.	CDA9-025	Scale	NTS
Drawing No:	CD3105	Rev	Sheet
		2	1 of 1
Drawn by: R Northey	Date: 21 AUG 2020		
Mould No: X	Tooling:		