

This drawing is the property of Cathodic Anodes Australasia. To be used with permission only.
 This drawing becomes an uncontrolled document once issued as hard or electronic copy.
 Customer to confirm current revision of drawing prior to ordering.

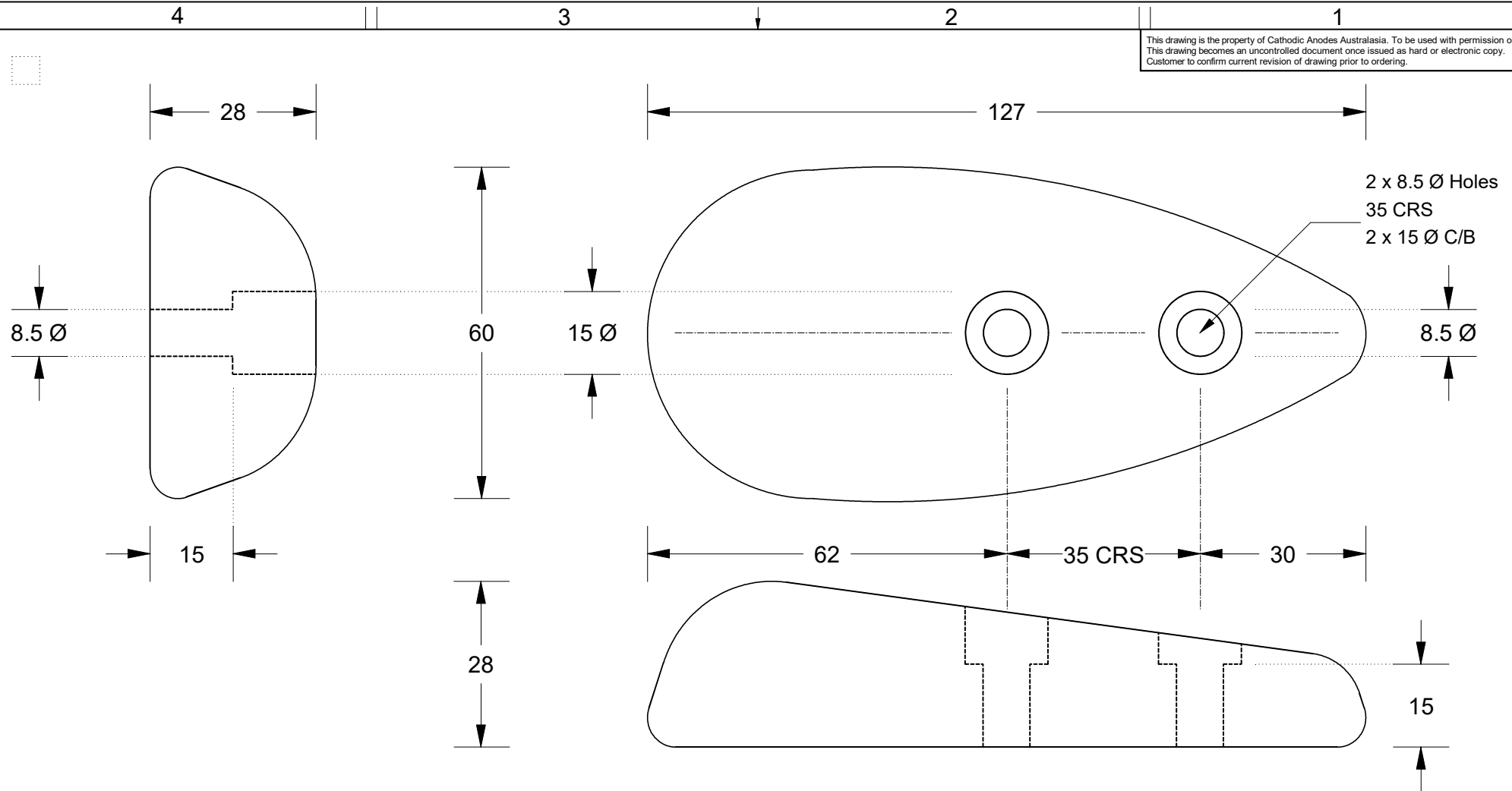

All dimensions are in mm (nominal)

Chemical Composition Limits			Alloy:
Standard: AS2239* (Most current revision)			Z1
Zinc			
Element	min.	max.	
Cadmium	0.025	0.07	
Aluminium	0.10	0.50	
Silicon	-	0.005	
Copper	-	0.005	
Iron	-	0.005	
Lead	-	0.006	
Other Impurities			
- each	-	0.005	
- total	-	0.02	
Zinc	remainder		

* Corresponds to MIL-DTL-18001L alloy composition

Notes

- Anodes are cast to comply with CAA's standard casting tolerances
- All sharp edges removed for safe handling
- Anode insert material to meet relevant Australian/International specifications



Rev	Details of Change(s)	Date	Drawn	Verified
1	For Manufacture	08 August 2011	R.N.	R.G.
2	Holes > 8 to 8.5 mm Ø	16 August 2011	R.N.	R.G.
2	3rd Angle added, CAA Logo	28 April 2014	R.N.	R.G.

Nett Weight Kg (nominal)	Gross Weight Kg (nominal)
0.90	N/A



Cathodic Anodes Australasia

cathodicanodes.com.au

Product			
Zinc Anode			
Part no.		Scale	
CDZ3-5H Type 2		1 : 1	
Drawing No: CD3089		Rev	Sheet
		3	1 of 1
Drawn by: R Northey Date: 28 APR 2014			
Mould No: 70			

