

This drawing is the property of Cathodic Anodes Australasia. To be used with permission only.  
 This drawing becomes an uncontrolled document once issued as hard or electronic copy.  
 Customer to confirm current revision of drawing prior to ordering.

6 x M6 x 25mm 304 S/S Socket Head Cap Screws, 6 x M6 304 S/S Internal Tooth Washers

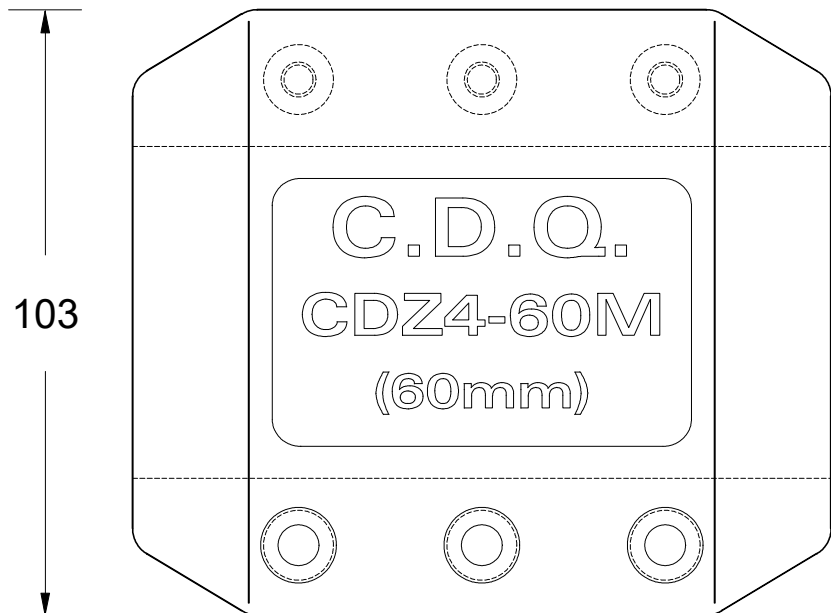

103

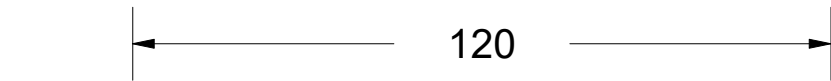
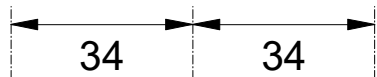

34

34

60 Ø

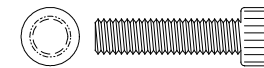
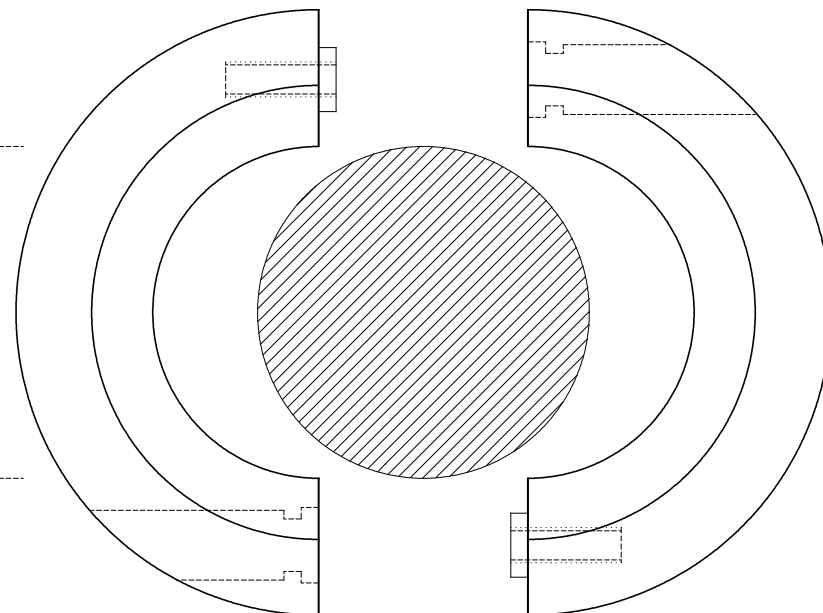

TAP - 6 x M6

**Intended Use For 60mm METRIC Shafts**

Chemical Composition Limits		Alloy:
Standard: AS2239* (Most current revision)		<b>Z1</b>
Zinc		
Element	min.	max.
Cadmium	0.025	0.07
Aluminium	0.10	0.50
Silicon	-	0.005
Copper	-	0.005
Iron	-	0.005
Lead	-	0.006
Other Impurities	-	0.005
- each	-	0.005
- total	-	0.02
Zinc	-	remainder

\* Corresponds to MIL-DTL-18001L alloy composition

Notes

1. Anodes are cast to comply with CAA's standard casting tolerances
2. All sharp edges removed for safe handling
3. Anode insert material to meet relevant Australian/International specifications



All dimensions are in mm (nominal)

Rev	Details of Change(s)	Date	Drawn	Verified
1	For Manufacture	25 October 2019	R.N.	R.G.

Nett Weight Kg (nominal)	Gross Weight Kg (nominal)
<b>4.25</b>	<b>4.30</b>



Cathodic Anodes Australasia

[cathodicanodes.com.au](http://cathodicanodes.com.au)

Product			
<b>Zinc Anode - Shaft Anode</b>			
Part no.	Scale		Sheet
<b>CDZ4 - 60M HD</b>	<b>1 : 1.25</b>		<b>1 of 1</b>
Drawing No:	<b>CD2537</b>	Rev	Sheet
Drawn by: R Northey	Date: 25 OCT 2019	<b>1</b>	<b>1 of 1</b>