

This drawing is the property of Cathodic Anodes Australasia. To be used with permission only.  
 This drawing becomes an uncontrolled document once issued as hard or electronic copy.  
 Customer to confirm current revision of drawing prior to ordering.

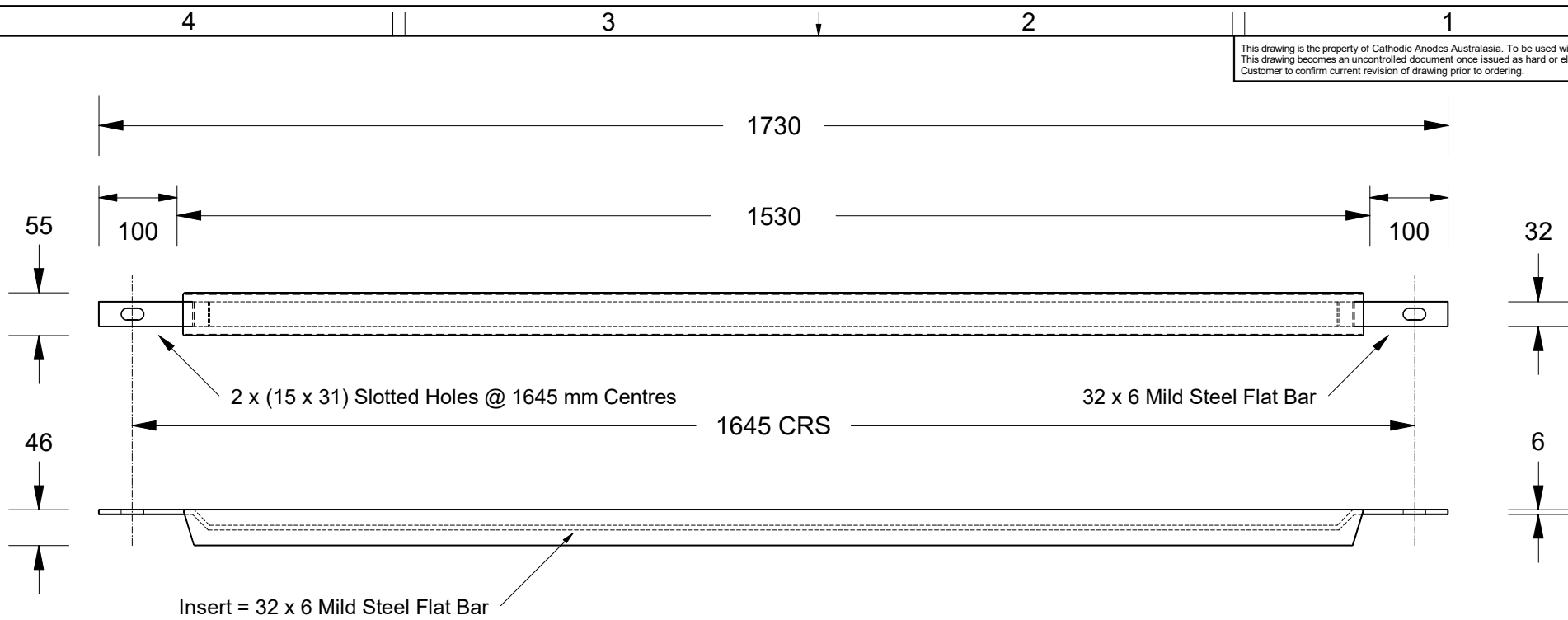

(Anode - Nominal 1500 x 50 x 50) - (1500 on Centreline)

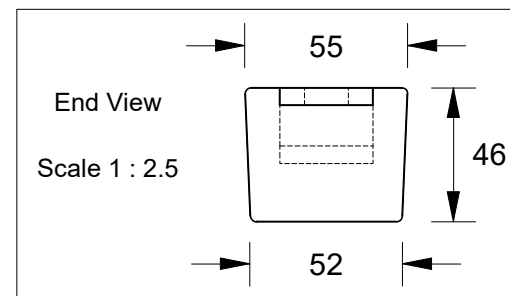

All dimensions are in mm (nominal)

Chemical Composition Limits			Alloy: <b>Z1</b>
Standard: AS2239* (Most current revision)			
Zinc			
Element	min.	max.	
Cadmium	0.025	0.07	
Aluminium	0.10	0.50	
Silicon	-	0.005	
Copper	-	0.005	
Iron	-	0.005	
Lead	-	0.006	
Other Impurities			
- each	-	0.005	
- total	-	0.02	
Zinc	remainder		

\* Corresponds to MIL-DTL-18001L alloy composition

Notes

- Anodes are cast to comply with CAA's standard casting tolerances
- All sharp edges removed for safe handling
- Anode insert material to meet relevant Australian/International specifications



Rev	Details of Change(s)	Date	Drawn	Verified
1	For Quotation	06 December 2018	R.N.	D.K.
2	Insert changed to 32 x 6 MSFB throughout Anode	26 June 2019	R.N.	L.S.

Nett Weight Kg (nominal)	Gross Weight Kg (nominal)
<b>24.5</b>	<b>27.1</b>



Cathodic Anodes Australasia

[cathodicanodes.com.au](http://cathodicanodes.com.au)

Product <b>Zinc Anode</b>			
Part no. <b>CDZ8-60S 27kg F-M 1645 CRS</b>	Scale <b>1 : 7.5</b>		
Drawing No: <b>CD2481</b>	Rev <b>2</b>	Sheet <b>1 of 1</b>	
Drawn by: R Northey	Date: 26 JUN 2019		
Mould No:	Tooling:		

