

This drawing is the property of Cathodic Anodes Australasia. To be used with permission only.
 This drawing becomes an uncontrolled document once issued as hard or electronic copy.
 Customer to confirm current revision of drawing prior to ordering.

MATERIAL: D.R. BRASS

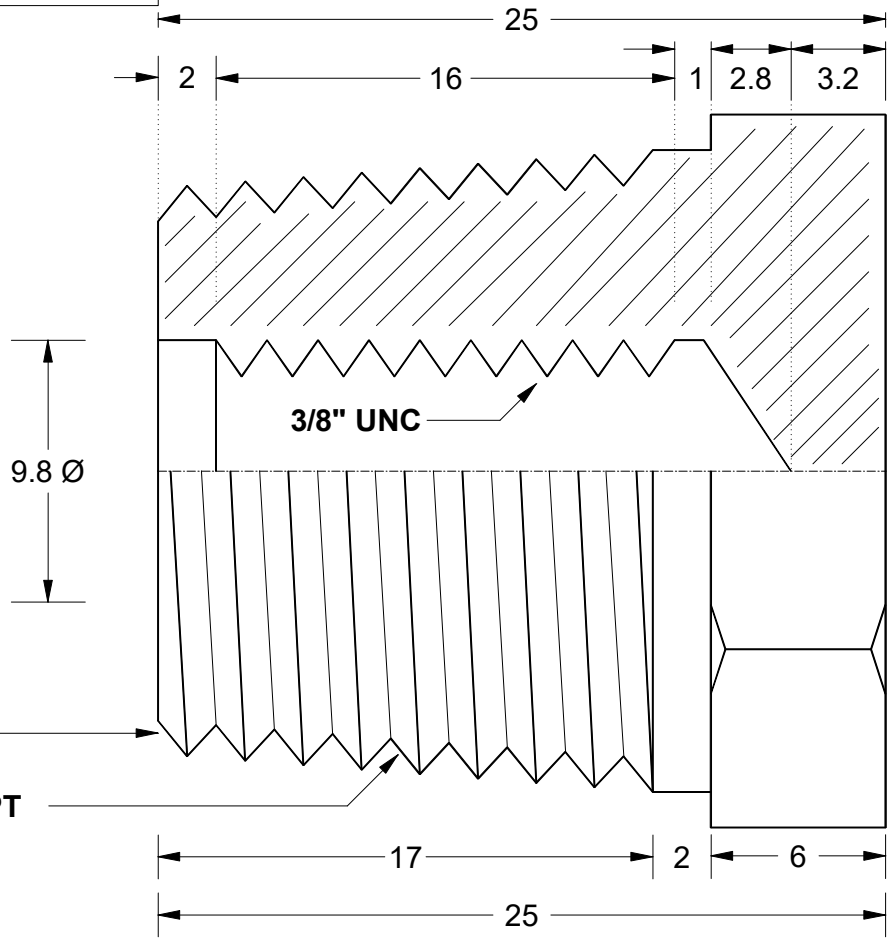

45° CHAMFER
ALL THREAD LEADS

1/2" NPT

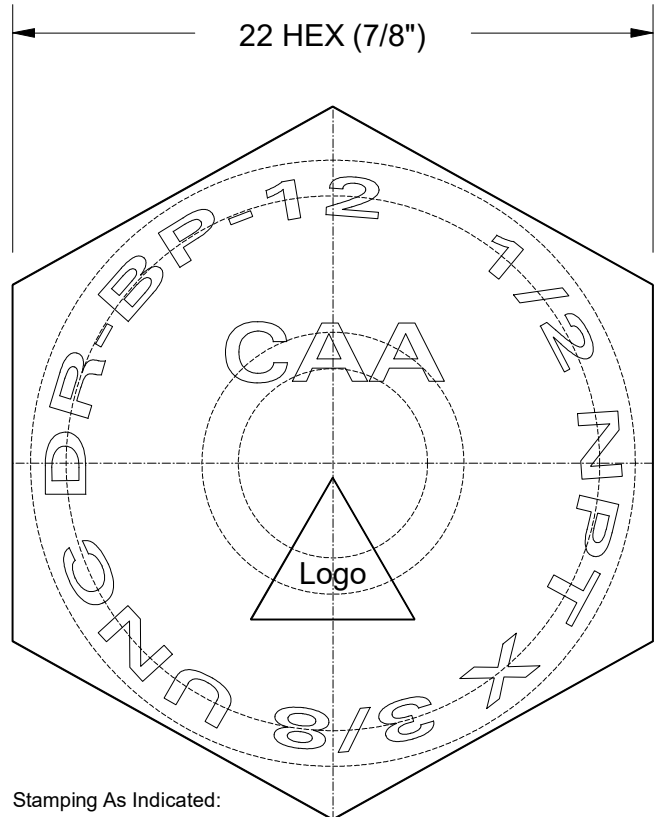

Stamping As Indicated:

1/2 NPT X 3/8 UNC DR-BP-12 CAA (Font Size - Approximately 3 mm)

As per Samples Supplied in June 2020  = Australian Made Logo

MATERIAL: Dezincification Resistant Brass

AS 1567 Grade 352

(UNS Equivalent C35330)

1/2" NPT x 3/8" UNC

Rev	Details of Change(s)	Date	Initials
1	For Manufacture	27 SEP 18	R.N.
2	Hex Head Stamping Added	15 JUL 19	R.N.
3	Stamping On Head Changed	09 NOV 20	R.N.



Cathodic Anodes Australasia

cathodicanodes.com.au

Product		D.R. Brass Plug for Zinc Anode(s)	
Part no.	BP12 (Brass Plug 12)	Scale	N.T.S.
Drawing No:	CD2467	Rev	3
Drawn by: R Northey	Date: 09 NOV 2020	Sheet	1 of 1
		