

Component View - Scale 1 : 5

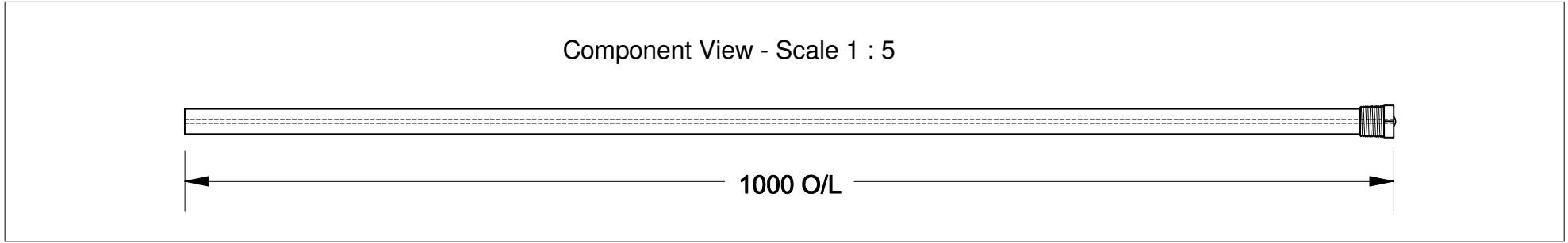

3.4 Ø Mild Steel (Wire) Core - Welded at Cap End

3/4 BSPT (Mild Steel) Cap

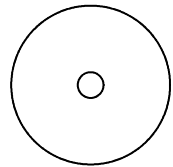

21 Ø

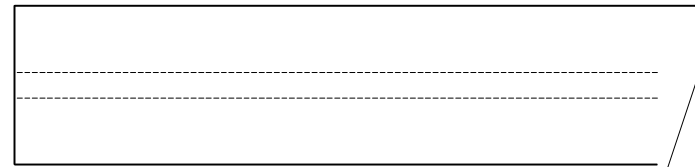

21 mm Ø High Potential (ASTM B843-07 - M1C) Magnesium Rod

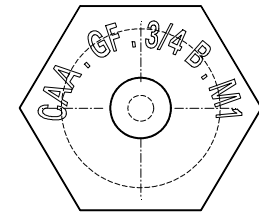
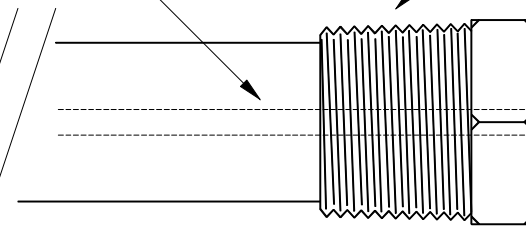

27 Hex

Hex Plug To Be Hard Stamped and Colour Coded GREEN

Note: Caps to be Chemically Blackened

Chemical Composition Limits		Alloy:
Standard: ASTM B843-07		M1C
Magnesium - High Potential		
Element	Min	Max
Aluminium	—	0.01
Zinc	—	—
Manganese	0.50	1.30
Silicon	—	0.05
Copper	—	0.02
Nickel	—	0.001
Iron	—	0.03
Calcium	—	—
Other Impurities	- Each	0.05
	- Total	0.30
Magnesium		remainder

Notes

- Anodes are cast to comply with CAA's standard casting tolerances.
- All sharp edges removed for safe handling.

Rev	Details of Change(s)	Nett Weight		Gross Weight	
		Drawn	Initials	Verified	Initials
1	2013 Catalogue Version	01 NOV 17	R.N.	01 NOV 17	R.G.
2	Stamping And Painting Added To Head	08 MAY 20	R.N.	08 MAY 20	L.S.
3	Stamping Modified, Blackened Finish Noted	25 JUN 20	R.N.	25 JUN 20	L.S.

0.672

0.722



Cathodic Anodes Australasia

cathodicanodes.com.au

Product	
Magnesium Anode	
Part no.	Scale
CDMR-M1-21-1000-75P	NTS
Drawing No: CD2407	Rev Sheet
	3 1 of 1
Drawn by: R Northey Date: 25 JUN 2020	
All dimensions are in mm (nominal)	

