

This drawing is the property of Cathodic Anodes Australasia. To be used with permission only. This drawing becomes an uncontrolled document once issued as hard or electronic copy. Customer to confirm current revision of drawing prior to ordering.

"NO SHARP EDGES"

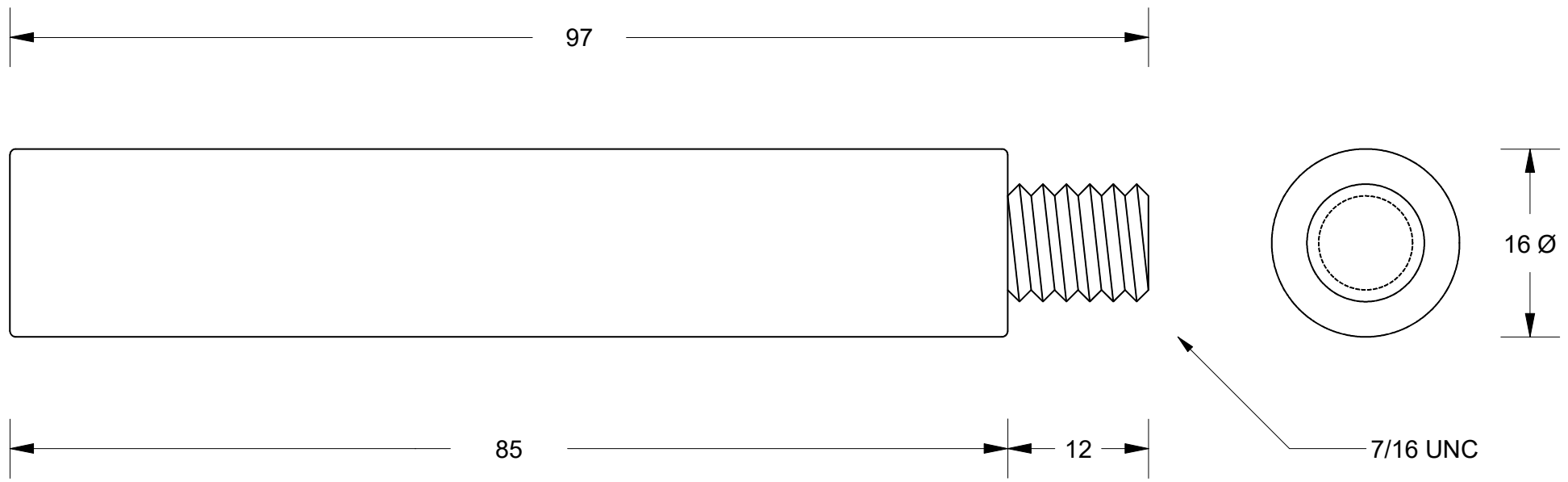

Chemical Composition Limits			Alloy: Z1
Element	min.	max.	
Standard: AS2239* (Most current revision)			
Zinc			
Cadmium	0.025	0.07	
Aluminium	0.10	0.50	
Silicon	-	0.005	
Copper	-	0.005	
Iron	-	0.005	
Lead	-	0.006	
Other Impurities			
- each	-	0.005	
- total	-	0.02	
Zinc	remainder		

- Notes
1. Anodes are cast to comply with CAA's standard casting tolerances
 2. All sharp edges removed for safe handling
 3. Anode insert material to meet relevant Australian/International specifications



Rev	Details of Change(s)	Date	Drawn	Verified
1	For Manufacture	19 Oct 2016	R.N.	J.L.

Nett Weight Kg (nominal)	Gross Weight Kg (nominal)
0.100	N/A

CAA
Cathodic Anodes Australasia

cathodicanodes.com.au

Product Zinc Anode	
Part no. CDZ9-004 (Long)	Scale 2 : 1
Drawing No: CD2327	Rev 1 Sheet 1 of 1
Drawn by: R Northey Date: 19 OCT 2016	

All dimensions are in mm (nominal)

* Corresponds to MIL-DTL-18001L alloy composition