

This drawing is the property of Cathodic Anodes Australasia. To be used with permission only.  
 This drawing becomes an uncontrolled document once issued as hard or electronic copy.  
 Customer to confirm current revision of drawing prior to ordering.

Side View

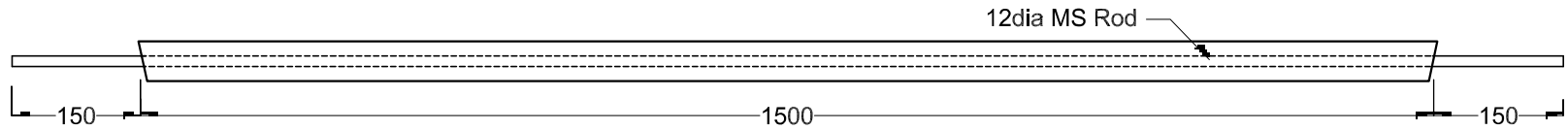

End View

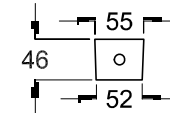

- Notes
1. Anodes are cast to comply with CAA's standard casting tolerances
  2. All sharp edges removed for safe handling
  3. Anode insert material to meet relevant Australian/International specifications

Chemical Composition Limits		Alloy:
Element	min.	max.
Standard: AS2239* (Most current revision)		<b>Z1</b>
Zinc		
Cadmium	0.025	0.07
Aluminium	0.10	0.50
Silicon	-	0.005
Copper	-	0.005
Iron	-	0.005
Lead	-	0.006
Other Impurities		
- each	-	0.005
- total	-	0.02
Zinc		remainder

\* Corresponds to MIL-DTL-18001L alloy composition



Nett Weight Kg (nominal)	Gross Weight Kg (nominal)
<b>25.2</b>	<b>26.8</b>

Rev	Details of Change(s)	Date	Drawn	Verified
1	For manufacture	27FEB14	<i>BL</i>	<i>JL</i>

**CAA**  
 Cathodic Anodes Australasia  
[cathodicanodes.com.au](http://cathodicanodes.com.au)

All dimensions are in mm (nominal)

Product <b>Zinc Anode</b>		Scale <b>1 to 8</b>
Part no. <b>CDZ8-60S 27kg (1800 core)</b>		Rev Sheet <b>1 1 of 1</b>
Drawing no. <b>CD1693</b>		Drawn by: BL Verified by: JL Date: 27FEB14
Mould no. 6		