

This drawing is the property of Cathodic Anodes Australasia. To be used with permission only.  
 This drawing becomes an uncontrolled document once issued as hard or electronic copy.  
 Customer to confirm current revision of drawing prior to ordering.

Side View

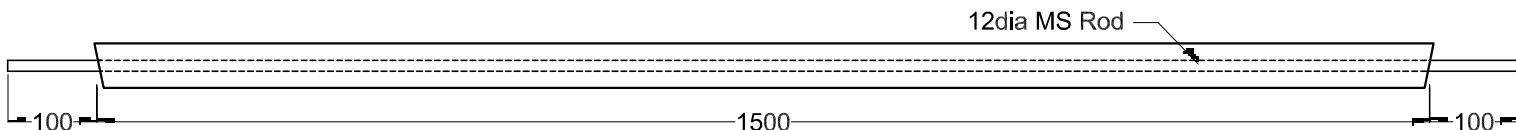

End View

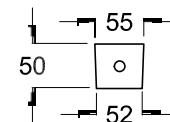

All dimensions are in mm (nominal)

Chemical Composition Limits			Alloy: <b>A6</b>
Standard: AS2239 (Most current revision)			
Aluminium			
Element	min.	max.	
Zinc	2.0	6.0	
Indium	0.01	0.02	
Cadmium	-	0.005	
Silicon	0.08	0.12	
Iron	-	0.12	
Magnesium	-	0.02	
Titanium	-	0.02	
Copper	-	0.006	
Tin	-	0.02	
Other Impurities			
- each	-	0.02	
- total	-	0.05	
Aluminium	remainder		

Notes

1. Anodes are cast to comply with CAA's standard casting tolerances
2. All sharp edges removed for safe handling
3. Anode insert material to meet relevant Australian/International specifications



Nett Weight Kg (nominal)	Gross Weight Kg (nominal)
<b>10.25</b>	<b>11.80</b>

Rev	Details of Change(s)	Date	Drawn	Verified
2	CAA template	02MAY14	<i>BL</i>	<i>JL</i>
1	For manufacture	02JUL09	<i>BL</i>	

**CAA**  
 Cathodic Anodes Australasia  
 cathodicanodes.com.au

Product <b>Aluminium Anode</b>		Scale <b>1 to 8</b>
Part no. <b>CDA-10S Type1</b>		Rev Sheet <b>2 1 of 1</b>
Drawing no. <b>CD1224</b>		Drawn by: BL Verified by: JL Date: 02MAY14
Mould No: 6		