

This drawing is the property of Cathodic Anodes Australasia. To be used with permission only.
 This drawing becomes an uncontrolled document once issued as hard or electronic copy.
 Customer to confirm current revision of drawing prior to ordering.

Side View

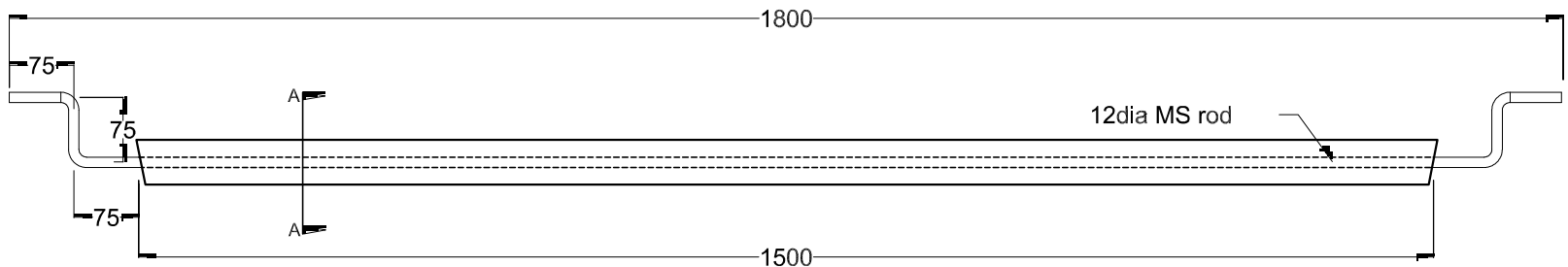

Section A-A

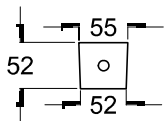

Chemical Composition Limits		Alloy:	
Element	min.	max.	Z1
Standard: AS2239* (Most current revision)			
Zinc			
Cadmium	0.025	0.07	
Aluminium	0.10	0.50	
Silicon	-	0.005	
Copper	-	0.005	
Iron	-	0.005	
Lead	-	0.006	
Other Impurities			
- each	-	0.005	
- total	-	0.02	
Zinc		remainder	

Notes

- Anodes are cast to comply with CAA's standard casting tolerances
- All sharp edges removed for safe handling
- Anode insert material to meet relevant Australian/International specifications



Nett Weight Kg (nominal)	Gross Weight Kg (nominal)
25.5	27.2

CAA
 Cathodic Anodes Australasia
cathodicanodes.com.au

Product Zinc Anode		Scale 1 to 8
Part no. CDZ8-60S 27kg		Rev Sheet 1 1 of 1
Drawing no. CD1077		
Drawn by: BL	Date: 12SEP08	
All dimensions are in mm (nominal)		

Rev	Details of Change(s)	Date	Initials
1	For manufacture	12SEP08	BL

* Corresponds to MIL-DTL-18001L alloy composition