

This drawing is the property of Cathodic Anodes Australasia. To be used with permission only.
 This drawing becomes an uncontrolled document once issued as hard or electronic copy.
 Customer to confirm current revision of drawing prior to ordering.

NO SHARP EDGES

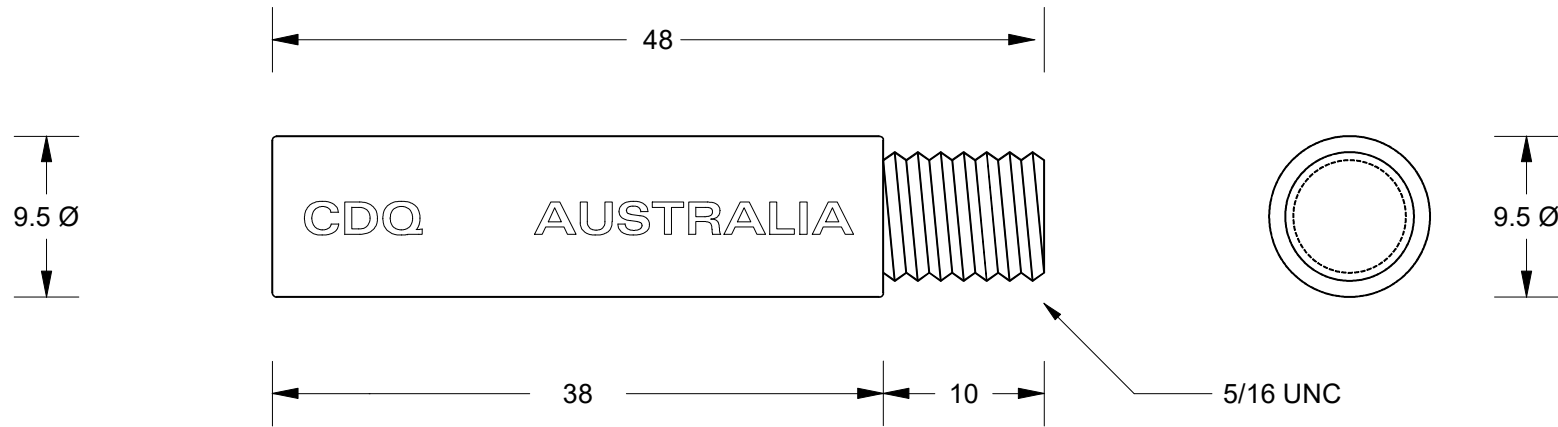

Part-Off 6mm from a stock CDZ9-033

Chemical Composition Limits		Alloy: Z1	
Standard: AS2239* (Most current revision)			
Zinc			
Element	min.	max.	
Cadmium	0.025	0.07	
Aluminium	0.10	0.50	
Silicon	-	0.005	
Copper	-	0.005	
Iron	-	0.005	
Lead	-	0.006	
Other Impurities	-	0.005	
- each	-	0.005	
- total	-	0.02	
Zinc	-	remainder	

* Corresponds to MIL-DTL-18001L alloy composition

Notes

1. Anodes are cast to comply with CAA's standard casting tolerances
2. All sharp edges removed for safe handling
3. Anode insert material to meet relevant Australian/International specifications



Rev	Details of Change(s)	Date	Drawn	Verified
1	For Manufacture	04 June 2020	R.N.	R.G.

Nett Weight Kg (nominal)	Gross Weight Kg (nominal)
0.018	N/A



Product Zinc Anode			
Part no. CDZ9-211		Scale 2.5 : 1	
Drawing No: CD2569		Rev 1	Sheet 1 of 1
Drawn by: R Northey		Date: 04 JUN 2020	

All dimensions are in mm (nominal)