

This drawing is the property of Cathodic Anodes Australasia. To be used with permission only. This drawing becomes an uncontrolled document once issued as hard or electronic copy. Customer to confirm current revision of drawing prior to ordering.

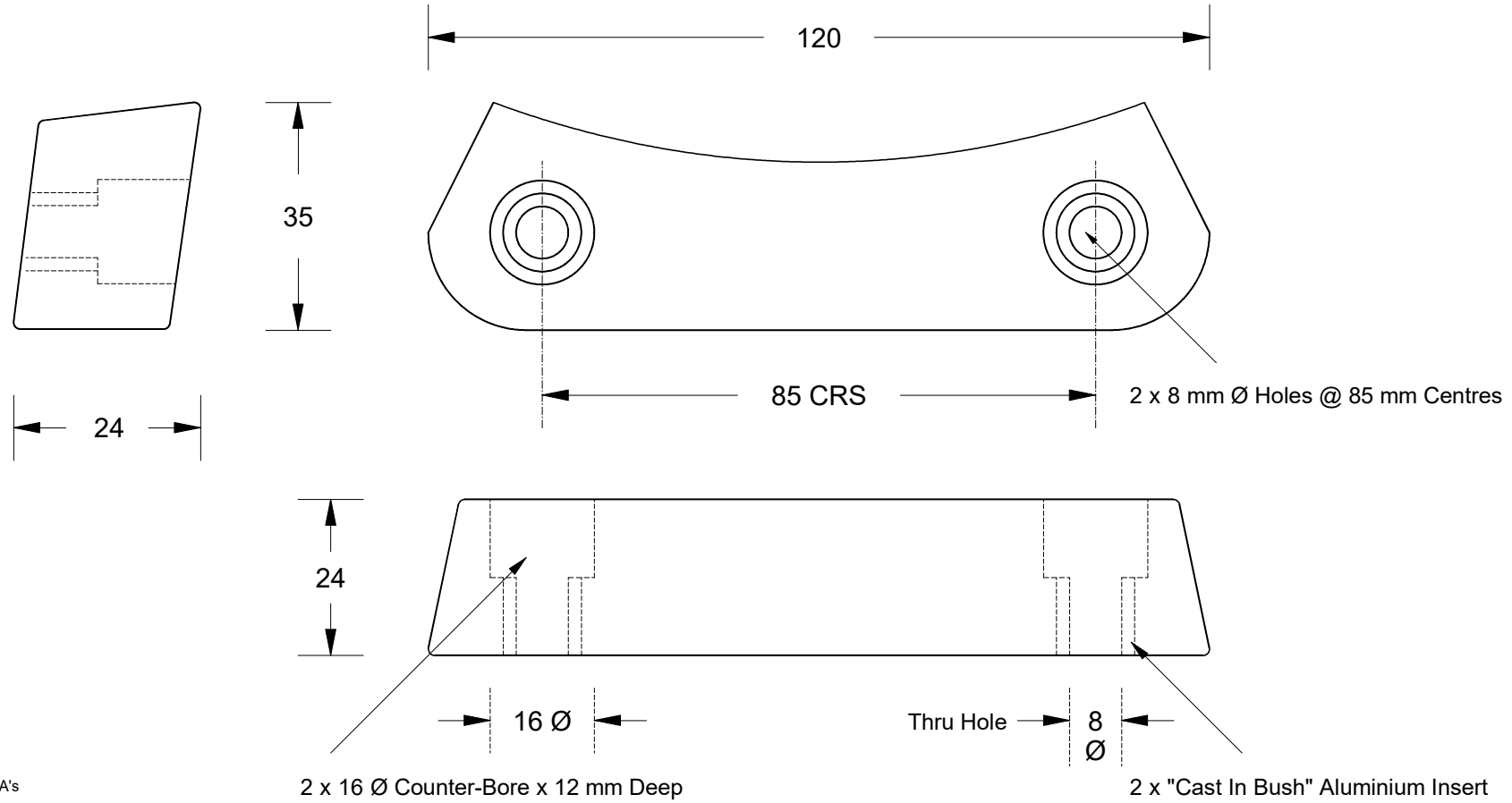

- Notes
1. Anodes are cast to comply with CAA's standard casting tolerances
 2. All sharp edges removed for safe handling
 3. Anode insert material to meet relevant Australian/International specifications

All dimensions are in mm (nominal)

Chemical Composition Limits		Alloy:	
Standard: MIL-DTL-24779A(SH)		24779A	
Aluminium (Most current revision)			
Element	min.	max.	
Zinc	4.0	6.5	
Indium	0.014	0.020	
Mercury	-	0.001	
Silicon	0.08	0.20	
Iron	-	0.090	
Copper	-	0.004	
Tin	-	0.001	
Aluminium	remainder		

Rev		Details of Change(s)		Date		Drawn		Verified	
1		Cathodic Diecasting Original		21 October 2018		R.N.		R.G.	

Nett Weight	Gross Weight
Kg (nominal)	Kg (nominal)
0.185	0.190

CAA
Cathodic Anodes Australasia
cathodicanodes.com.au

Product			
Aluminium Anode			
Part no.		Scale	
CDA9-204		1 : 1	
Drawing No: CD2471		Rev	Sheet
		1	1 of 1
Drawn by: R Northey		Date: 21 OCT 2018	