

This drawing is the property of Cathodic Anodes Australasia. To be used with permission only. This drawing becomes an uncontrolled document once issued as hard or electronic copy. Customer to confirm current revision of drawing prior to ordering.

Component View - Scale 1 : 1

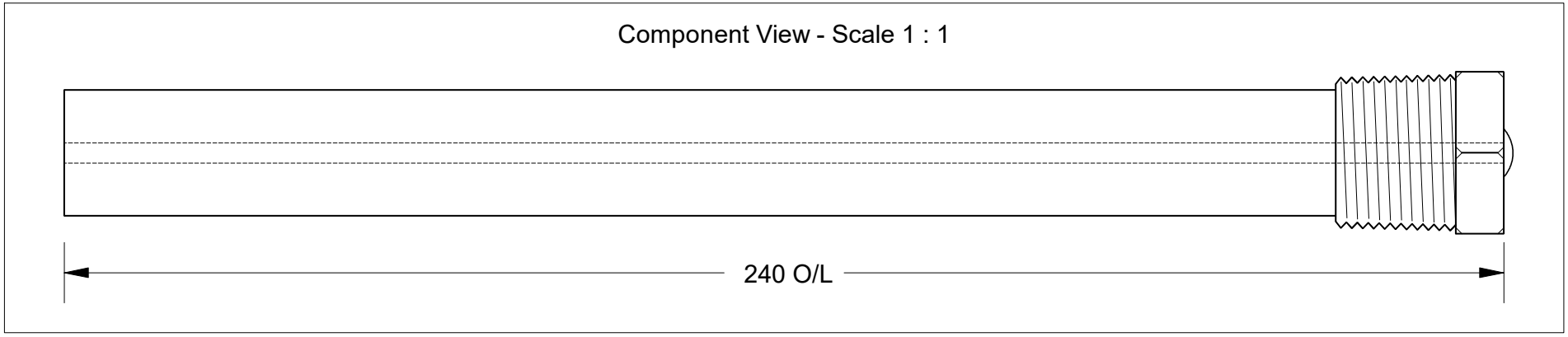

3.4 Ø Mild Steel (Wire) Core - Welded at Cap End

3/4 NPT (Mild Steel) Cap

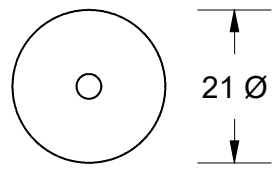

21 Ø

21 mm Ø Low Potential (AS2239-M2) Magnesium Rod

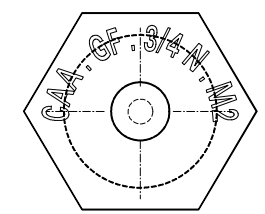
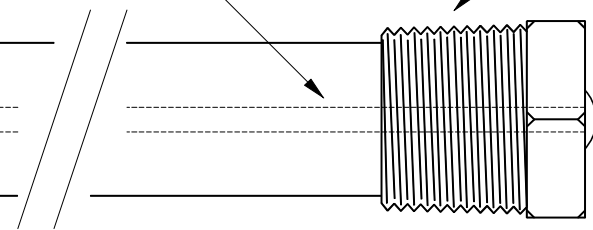

27 Hex

Hex Plug To Be Hard Stamped and Colour Coded BLACK

Note: Caps to be Chemically Blackened

Note: Suburban HWS common with Recreational Vehicles

Chemical Composition Limits		Alloy:
Standard: AS2239 (Most current revision)		M2
Magnesium. Low Potential		
Element	min.	max.
Aluminium	2.5	3.5
Zinc	0.7	1.3
Manganese	0.20	1.5
Silicon	-	0.05
Copper	-	0.006
Iron	-	0.003
Nickel	-	0.001
Calcium	-	0.04
Other Impurities	-	-
- each	-	-
- total	-	0.30
Magnesium	remainder	

- Notes
1. Anodes are cast to comply with CAA's standard casting tolerances
 2. All sharp edges removed for safe handling
 3. Anode insert material to meet relevant Australian/International specifications

Rev	Details of Change(s)	Nett Weight		Gross Weight	
		kg (nominal)	Initials	kg (nominal)	Initials
1	Anodes Online, E-Bay Versions	0.164	R.N.	0.214	R.G.
2	Stamping Modified, Blackened Finish Noted	25 JUN 20	R.N.	25 JUN 20	L.S.



cathodicanodes.com.au

Product		Suburban Magnesium Anode Assembly	
Part no.	CDMR-M2-21-240A-NPT	Scale	N T S
Drawing No:	CD2453	Rev	Sheet
		2	1 of 1
Drawn by: R Northey		Date: 25 JUN 2020	
All dimensions are in mm (nominal)			

