

This drawing is the property of Cathodic Anodes Australasia. To be used with permission only.
 This drawing becomes an uncontrolled document once issued as hard or electronic copy.
 Customer to confirm current revision of drawing prior to ordering.

Component View - Scale 1 : 1

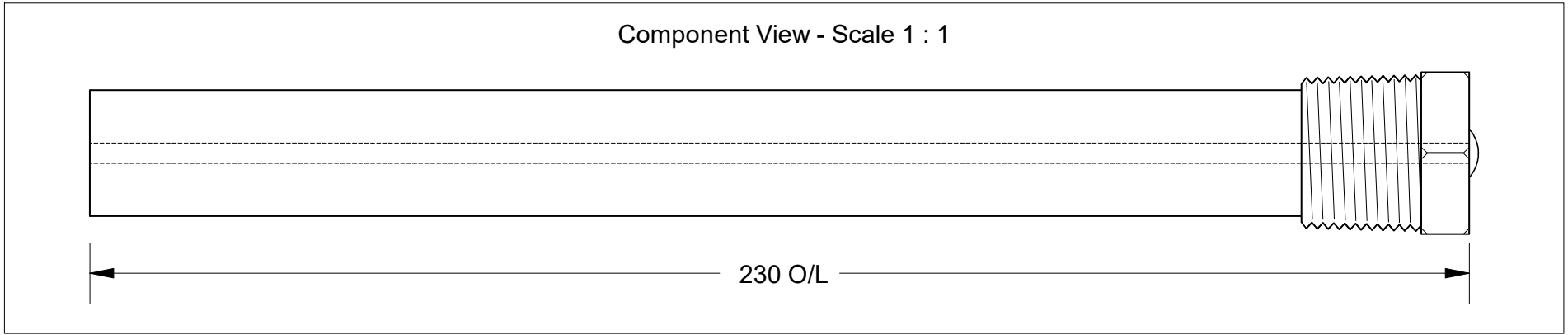

3.4 Ø Mild Steel (Wire) Core - Welded at Cap End

3/4 BSPT (Mild Steel) Cap

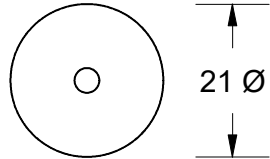

21 Ø

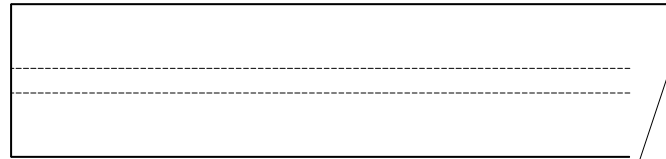

21 mm Ø High Potential (ASTM B843-07 - M1C) Magnesium Rod

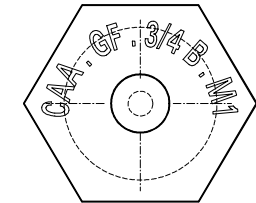
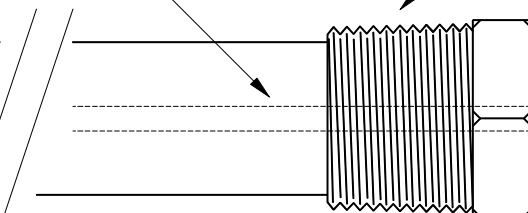

27 Hex

Hex Plug To Be Hard Stamped and Colour Coded GREEN

Note: Caps to be Chemically Blackened

Chemical Composition Limits			Alloy:
Standard: ASTM B843 (Most current revision)			M1C
Magnesium, High Potential			
Element	min.	max.	
Aluminium	-	0.01	
Zinc	-	0.02	
Manganese	0.50	1.3*	
Silicon	-	0.05	
Copper	-	0.02	
Iron	-	0.03	
Nickel	-	0.001	
Calcium	-	0.04	
Other Impurities			
- each	-	0.05	
- total	-	0.30	
Magnesium	remainder		

Notes

1. Anodes are cast to comply with CAA's standard casting tolerances
2. All sharp edges removed for safe handling
3. Anode insert material to meet relevant Australian/International specifications

Rev	Details of Change(s)	Nett Weight		Gross Weight	
		Drawn	Initials	Verified	Initials
		0.156		0.206	
1	2013 Catalogue Version	01 NOV 17	R.N.	01 NOV 17	R.G.
2	Stamping And Painting Added To Head	08 MAY 20	R.N.	08 MAY 20	L.S.
3	Stamping Modified, Blackened Finish Noted	25 JUN 20	R.N.	25 JUN 20	L.S.



Cathodic Anodes Australasia

cathodicanodes.com.au

Product			
Magnesium Anode			
Part no.		Scale	
CDMR-M1-21-0230-A		NTS	
Drawing No: CD2408		Rev	Sheet
		3	1 of 1
Drawn by: R Northey Date: 25 JUN 2020			
All dimensions are in mm (nominal)			

4

3

2

1