

This drawing is the property of Cathodic Anodes Australasia. To be used with permission only.
 This drawing becomes an uncontrolled document once issued as hard or electronic copy.
 Customer to confirm current revision of drawing prior to ordering.

NO SHARP EDGES

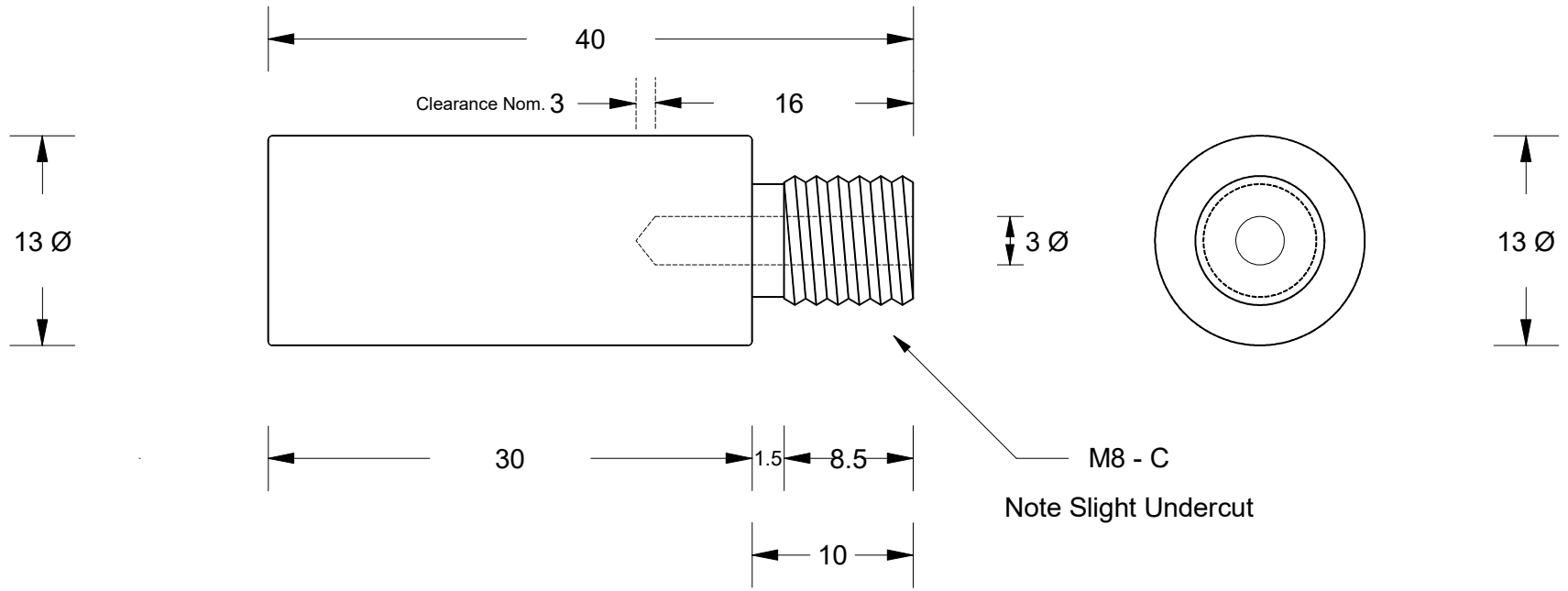

M8 - C
 Note Slight Undercut

Chemical Composition Limits			Alloy: Z1
Standard: AS2239* (Most current revision)			
Element	min.	max.	
Zinc			
Cadmium	0.025	0.07	
Aluminium	0.10	0.50	
Silicon	-	0.005	
Copper	-	0.005	
Iron	-	0.005	
Lead	-	0.006	
Other Impurities			
- each	-	0.005	
- total	-	0.02	
Zinc		remainder	

* Corresponds to MIL-DTL-18001L alloy composition

- Notes
1. Anodes are cast to comply with CAA's standard casting tolerances
 2. All sharp edges removed for safe handling
 3. Anode insert material to meet relevant Australian/International specifications

Rev		Details of Change(s)		Date	Drawn	Verified
1		For Manufacture		28 Feb 2017	R.N.	J.L.
2		Anode Diameter changed from 12.7 to 13 mm Ø		20 Feb 2019	R.N.	R.G.
3		Undercut reduced to 1.5mm. 3mm telltale added		26 Feb 2019	S.P.	R.G.
4		Drill Clearance Added (Nom)		28 May 2020	R.N.	S.P.

Nett Weight Kg (nominal)	Gross Weight Kg (nominal)
0.030	0.030

CAA
 Cathodic Anodes Australasia
 cathodicanodes.com.au

Product Zinc Anode		Scale 2.5 : 1	
Part no. Thales Special		Rev 4	Sheet 1 of 1
Drawing No: CD2361		Drawn by: R Northey Date: 28 MAY 2020	

All dimensions are in mm (nominal)