

This drawing is the property of Cathodic Anodes Australasia. To be used with permission only.
 This drawing becomes an uncontrolled document once issued as hard or electronic copy.
 Customer to confirm current revision of drawing prior to ordering.

Component View - Scale 1 : 1.25

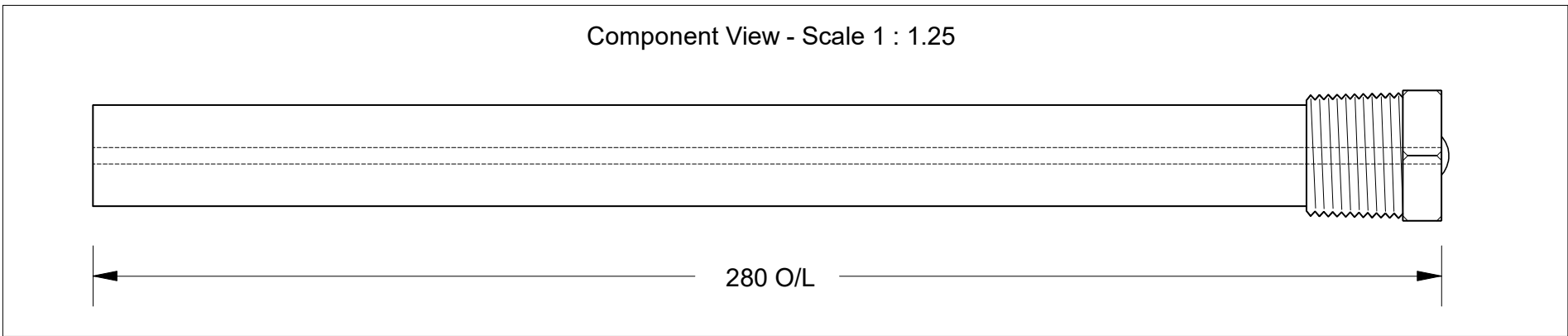

280 O/L

3.4 Ø Mild Steel (Wire) Core - Welded at Cap End

3/4 BSPT (Mild Steel) Cap

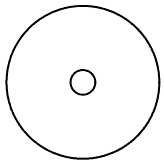

21 Ø

21 mm Ø Low Potential (AS2239-M2) Magnesium Rod

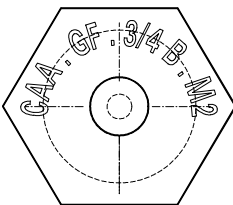
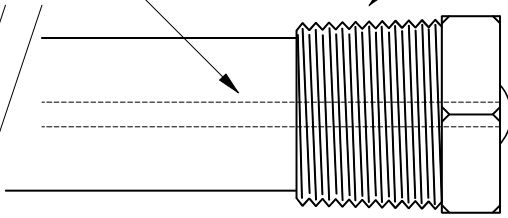

27 Hex

Hex Plug To Be Hard Stamped and Colour Coded BLACK

Note: Caps to be Chemically Blackened

Chemical Composition Limits		Alloy:
Element	min.	max.
Standard: AS2239 (Most current revision)		
Magnesium. Low Potential M2		
Aluminium	2.5	3.5
Zinc	0.7	1.3
Manganese	0.20	1.5
Silicon	-	0.05
Copper	-	0.006
Iron	-	0.003
Nickel	-	0.001
Calcium	-	0.04
Other Impurities	-	-
- each	-	-
- total	-	0.30
Magnesium	remainder	

- Notes
- Anodes are cast to comply with CAA's standard casting tolerances
 - All sharp edges removed for safe handling
 - Anode insert material to meet relevant Australian/International specifications

Rev	Details of Change(s)	Nett Weight		Gross Weight	
		Drawn	Initials	Verified	Initials
1	2013 Catalogue Version	27 APR 16	R.N.	27 APR 16	R.G.
2	Stamping And Painting Added To Head	08 MAY 20	R.N.	08 MAY 20	L.S.
3	Stamping Modified, Blackened Finish Noted	25 JUN 20	R.N.	25 JUN 20	L.S.

Nett Weight Kg (nominal)	Gross Weight Kg (nominal)
0.190	0.240



Cathodic Anodes Australasia

cathodicanodes.com.au

Product	
Magnesium Anode	
Part no.	Scale
CDMR-M2-21-0280-A	NTS
Drawing No: CD2242	Rev Sheet
	3 1 of 1
Drawn by: R Northey Date: 25 JUN 2020	
All dimensions are in mm (nominal)	

4

3

2

1