

This drawing is the property of Cathodic Anodes Australasia. To be used with permission only.
 This drawing becomes an uncontrolled document once issued as hard or electronic copy.
 Customer to confirm current revision of drawing prior to ordering.

Standard Casting Taper and Radius Apply

NO SHARP EDGES

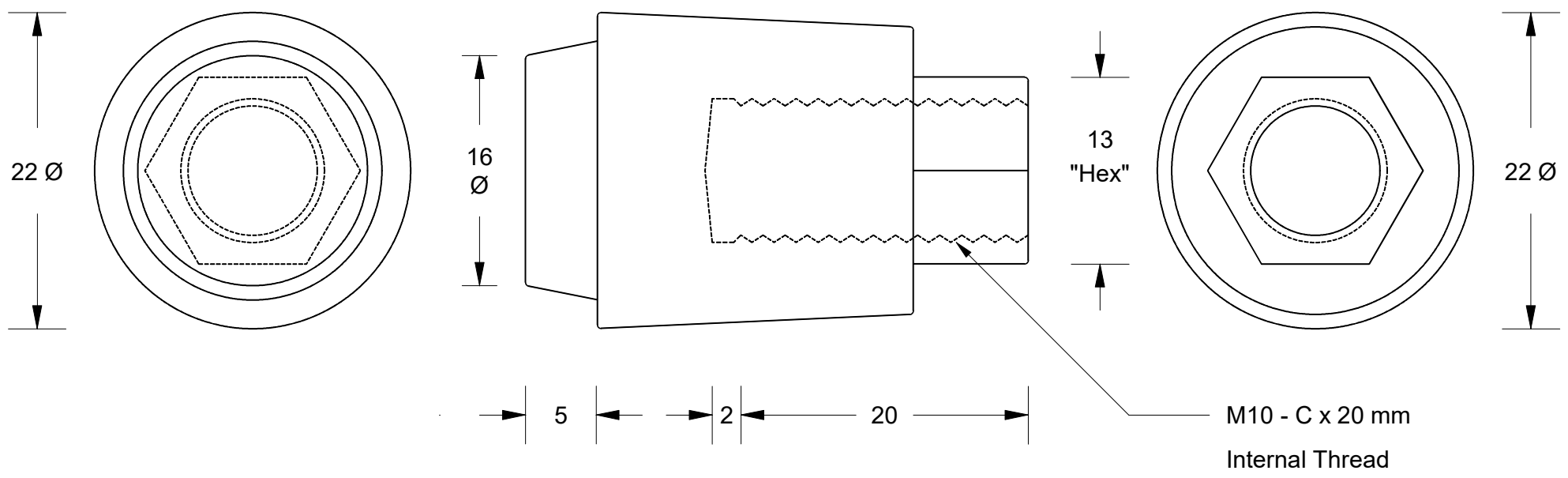

Chemical Composition Limits			Alloy: Z1
Standard: AS2239* (Most current revision)			
Zinc			
Element	min.	max.	
Cadmium	0.025	0.07	
Aluminium	0.10	0.50	
Silicon	-	0.005	
Copper	-	0.005	
Iron	-	0.005	
Lead	-	0.006	
Other Impurities			
- each	-	0.005	
- total	-	0.02	
Zinc	remainder		

* Corresponds to MIL-DTL-18001L alloy composition

- Notes
1. Anodes are cast to comply with CAA's standard casting tolerances
 2. All sharp edges removed for safe handling
 3. Anode insert material to meet relevant Australian/International specifications

Rev	Details of Change(s)	Date	Drawn	Verified
1	Cathodic Diecasting Original	21 June 2011	R.N.	R.G.
2	2013 Catalogue Version (CAA Logo)	23 March 2015	R.N.	R.G.

Nett Weight Kg (nominal)	Gross Weight Kg (nominal)
0.030	0.030

CAA
 Cathodic Anodes Australasia
 cathodicanodes.com.au

Product Zinc Anode		Scale 2.5 : 1	
Part no. CDZ9-106		Rev 2	Sheet 1 of 1
Drawing No: CD2153		Date: 23 MAR 2015	
Drawn by: R Northey		Date: 23 MAR 2015	

All dimensions are in mm (nominal)