

This drawing is the property of Cathodic Anodes Australasia. To be used with permission only. This drawing becomes an uncontrolled document once issued as hard or electronic copy. Customer to confirm current revision of drawing prior to ordering.

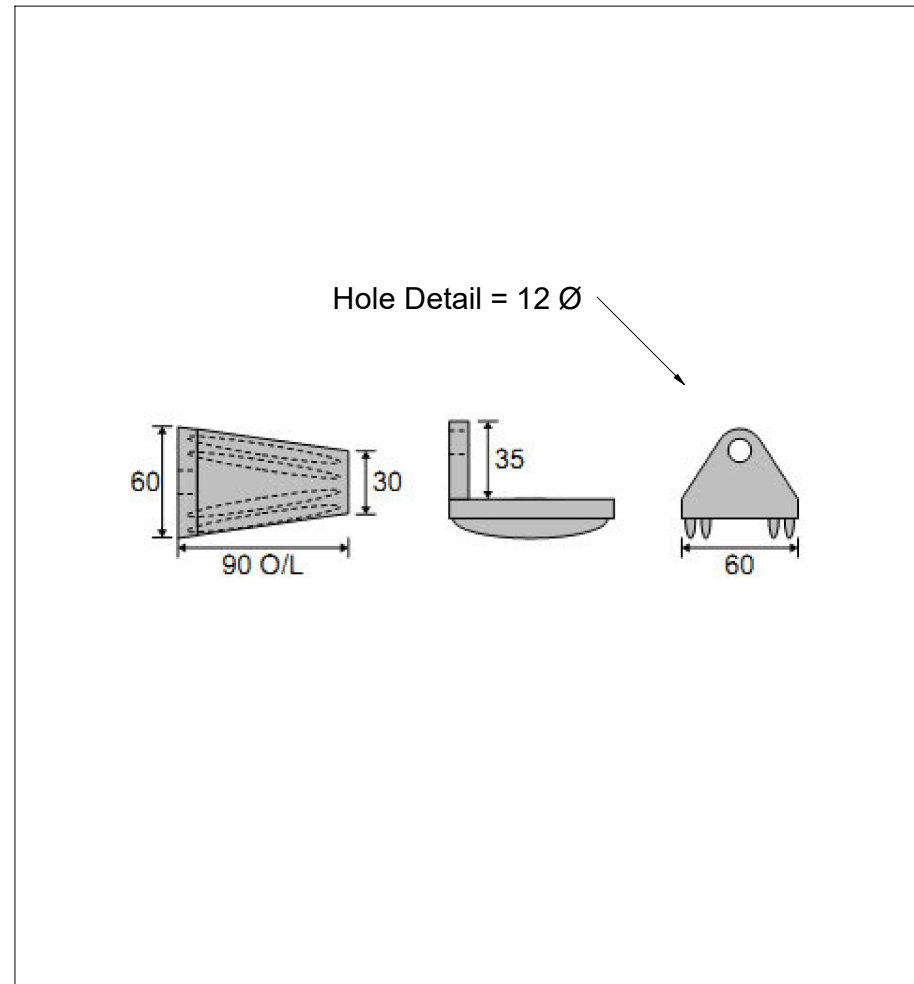

Jet Engine Bracket Anode - Small
Replaces Genuine Part: 542-15062

All dimensions are in mm (nominal)

| Chemical Composition Limits | | Alloy: Z1 |
|---|-----------|---------------------|
| Standard: AS2239* (Most current revision) | | |
| Zinc | | |
| Element | min. | max. |
| Cadmium | 0.025 | 0.07 |
| Aluminium | 0.10 | 0.50 |
| Silicon | - | 0.005 |
| Copper | - | 0.005 |
| Iron | - | 0.005 |
| Lead | - | 0.006 |
| Other Impurities | | |
| - each | - | 0.005 |
| - total | - | 0.02 |
| Zinc | remainder | |

* Corresponds to MIL-DTL-18001L alloy composition

Notes

1. Anodes are cast to comply with CAA's standard casting tolerances
2. All sharp edges removed for safe handling
3. Anode insert material to meet relevant Australian/International specifications

| Rev | Details of Change(s) | Date | Drawn | Verified |
|-----|--|-------------|-------|----------|
| 1 | Cathodic Diecasting Original | 23 Jun 2011 | R.N. | R.G. |
| 2 | 2013 / 2019 Catalogue Version (CAA Logo) | 20 Aug 2020 | R.N. | R.G. |
| | | | | |
| | | | | |

| Nett Weight Kg (nominal) | Gross Weight Kg (nominal) |
|-----------------------------|------------------------------|
| 0.450 | 0.450 |

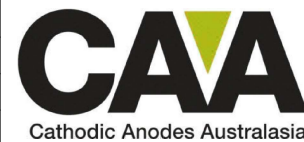

cathodicanodes.com.au

| | | | |
|---------------------------------------|--|----------------------|------------------------|
| Product Zinc Anode | | Scale NTS | |
| Part no. CDZ9-104 | | Rev 2 | Sheet 1 of 1 |
| Drawing No: CD2151 | | | |
| Drawn by: R Northey Date: 20 AUG 2020 | | Mould No: X Tooling: | |