

This drawing is the property of Cathodic Anodes Australasia. To be used with permission only. This drawing becomes an uncontrolled document once Issued as hard or electronic copy. Customer to confirm current revision of drawing prior to ordering.

SIDE VIEW

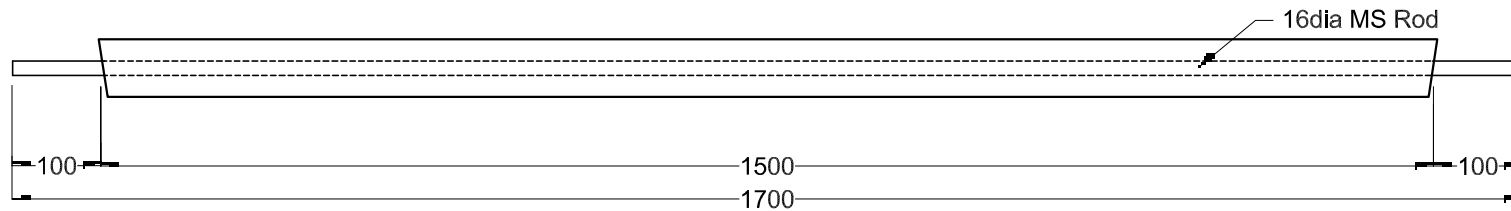

END VIEW

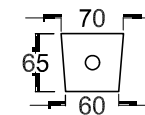

Chemical Composition Limits		Alloy:
Standard: AS2239* (Most current revision)		Z1
Element	min.	max.
Cadmium	0.025	0.07
Aluminium	0.10	0.50
Silicon	-	0.005
Copper	-	0.005
Iron	-	0.005
Lead	-	0.006
Other Impurities		
- each	-	0.005
- total	-	0.02
Zinc	remainder	

- Notes
1. Anodes are cast to comply with CAA's standard casting tolerances
 2. All sharp edges removed for safe handling
 3. Anode Insert material to meet relevant Australian/International specifications



* Corresponds to MIL-21L-18001L alloy composition

Nett Weight Kg (nominal)	Gross Weight Kg (nominal)
42.3	45.0

Rev	Details of Change(s)	Date	Initials
1	For manufacture	16DEC08	<i>BL</i>
2	Logo Changed to CAA from CDQ	01MAR17	R.N.

CAA
Cathodic Anodes Australasia
cathodicanodes.com.au

Product Zinc Anode		Scale 1 to 8	
Part no. CDZ8-60S 45kg		Rev	Sheet
Drawing no. CD1126		2	1 of 1
Drawn by: BL		Date: 16DEC08	
Mould no: 5	All dimensions are in mm (nominal)		

